



CAPTIVA

CUSTOM MDF INTERIOR DOORS





CAPTIVA

HANDCRAFTED IN NEW ENGLAND, CAPTIVA CUSTOM DOORS ARE SYNONYMOUS WITH QUALITY MATERIAL AND CRAFTSMANSHIP. WITH CAPTIVA CUSTOM MDF, WE HAVE COMBINED TRADITIONAL STILE AND RAIL CONSTRUCTION WITH ENVIRONMENTALLY-FRIENDLY MDF TO OFFER AN ALTERNATIVE TO ALL-WOOD INTERIOR DOORS. ALLOW YOURSELF TO BE CAPTIVATED WITH OUR NEW LINE OF CUSTOM INTERIOR MDF DOORS. ALL THE DESIGNS IN THIS CATALOG ARE ALSO AVAILABLE IN ANY WOOD SPECIES SO YOU CAN ENSURE A CONSISTENT DESIGN STYLE THROUGHOUT YOUR PROJECT.

Made in U.S.A.



ALL CAPTIVA CUSTOM DOORS ARE PROUDLY MADE IN OUR MANUFACTURING FACILITY IN SOMERSET, MASSACHUSETTS. WHEN YOU CHOOSE CAPTIVA CUSTOM DOORS, YOU NOT ONLY REDUCE YOUR CARBON FOOTPRINT BY USING A LOCAL MANUFACTURER, YOU HELP EMPLOY CRAFTSMEN IN YOUR COMMUNITY.



Why MDF?

Medium Density Fiberboard is an engineered wood product made from wood fibers and other recyclable materials. Denser and stronger than particle board, MDF is considered an environmentally-friendly material that is priced less than wood.

- √ Locally sourced
- √ Resists mold
- √ Easy to paint and holds paint finish well
- √ Recyclable

Why Captiva MDF?

- √ We source, build and ship locally, which helps minimize our carbon footprint
- √ We utilize a wood core which provides greater stability and allows for lighter weight than doors made with an MDF core
- √ We use solid wood edges so there is no need for wood wedge filler blocks
- √ We use solid wood mouldings for designs that use a raised moulding (like Bolection sticking) for durability
- √ Matching designs and profiles are available in your choice of wood species
- √ All door shapes and sizes are available up to 4'x10' in thickness of 1-3/8", 1-3/4", and 2-1/4"
- √ Matching fire-rated doors and door frames are available in 20, 45, 60, or 90-minute ratings
- √ A wide range of sticking and panel design options are available (*see pages 8 and 9*)
- √ Doors are available primed or factory-painted with your choice of stock or custom colors

Table of contents.

Steps to Designing Your Door	5
Anatomy of a Door	7
Door Construction	6-7
Panel and Sticking Options	8-9
Panel Doors	10-15
Louver Doors	15
Glass Door Options	16-17
Specialty Glass	18
Glass Doors	19-21
Double Door Arched Pairs	22-23
Modern Collection	24-25
Grooved and Beaded Doors	26-27
Dutch Doors	27
Barn Doors and Hardware	28-30
Transoms	31
Fire Doors	32-33
Jamb and Casings	34
Hardware	35
Commercial Capabilities	36
Prefinishing	37
Warranty	38
Architectural Specs	39



Designing your door.

EVERY CAPTIVA CUSTOM MDF DOOR STARTS WITH THE HIGHEST QUALITY MATERIAL AND CONSTRUCTION. WHAT MAKES A DOOR UNIQUE ARE THE CHOICES YOU MAKE. EACH DOOR IS CUSTOM BUILT TO EXACT SPECIFICATIONS. WE OFFER PANEL DOORS, AND GLASS DOORS AS WELL AS SPECIALTY DOORS INCLUDING LOUVER DOORS, BARN DOORS, PLANK DOORS, AND DUTCH DOORS.

CONFIGURATION

1

- Door Shape
- Transom

CONSTRUCTION

2

- Door Thickness

PANEL AND STICKING

3

- Standard Profile
- Custom Profile

GLASS

4

- Clear
- Decorative
- Pane Type
- Muntin Bars

FRAME

5

- Jamb
- Casing

HARDWARE

6

- Style
- Finish

FINISHING

7

- Primed
- Paint

Glossary of terms.

Joinery

The method used to join the door stiles to the top, bottom, and lock rails. Examples include mortise & tenon, dowels, beaded mortise & tenon, lag screws or bolts.

Lites

A framed opening in a door containing a pane of glass.

Muntin Bars

The narrow horizontal and/or vertical bars in a door lite that separate the individual panes of glass.

Panel Profile

The dimensional shape exposed edge of the outside perimeter of the panel.

Panels

The solid sections for the doors that are framed by the stiles and rails.

Rails

The horizontal components located at the top, bottom, and mid-sections of the door that extend between the stiles and frame the panels and lites.

Sticking

The profile that is moulded into the stiles and rails to frame and encase the panels or lites.

Stiles

The vertical components located at the left and right edges of the door.

Construction.

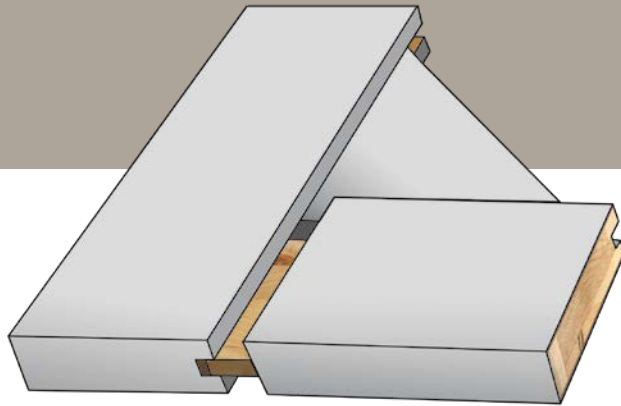

True mortise & tenon joinery
Solid wood core with MDF veneer
Solid MDF panels

Both the stiles and rails have a solid wood core to provide greater strength and stability. The MDF veneers on the stiles and rails allow for a smooth and consistent paint finish. Panels are solid MDF. Utilizing traditional mortise and tenon joinery, all pieces are hand fit together with industry's finest adhesives on all connections.

Dimensions.

Standard Stile and Rail Dimensions

To the right are the standard stile and rail dimensions that we use when constructing our Captiva MDF doors. If your project requires specific dimensions, we can modify these dimensions. **Note: Dimensions include sticking.** Certain hardware and prep requires larger stiles (i.e. mortise pockets). Doors built below standard dimensions may void warranty. 1/0 and 1/2 doors use 1-7/8" stiles.

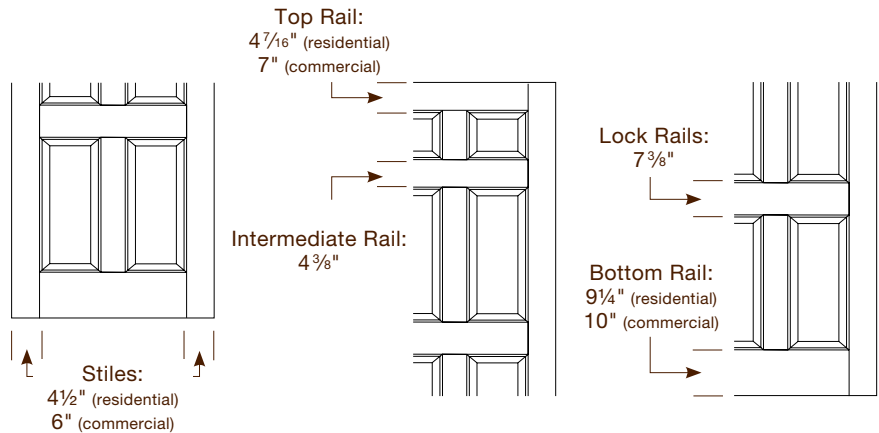

Flush Doors

With no stile or rail, Captiva Flush Series doors are constructed with a plywood core, hardwood edges and 1/8" MDF veneers. For 2-1/4" doors, or doors with grooves, a thicker veneer is used. 5 Year Warranty.

Thickness.

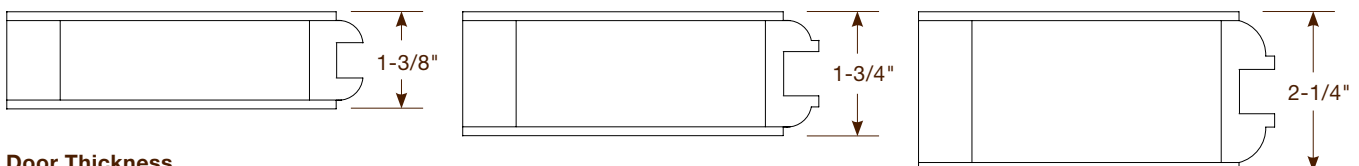

Door Thickness

We offer three standard door thicknesses: 1-3/8", 1-3/4" and 2-1/4". Custom thicknesses also available.

Door shapes.

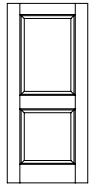

S
Square

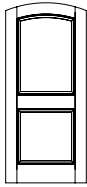

A
Arch

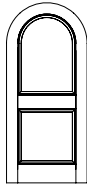

R
Round

TAKING INTO CONSIDERATION THE ARCHITECTURAL STYLE OF YOUR HOME OR THE LOOK THAT YOU WANT TO ACHIEVE, CAPTIVA MDF DOORS ARE AVAILABLE IN OUR STANDARD SHAPES OF SQUARE, ARCHED OR ROUND. WE ALSO MAKE CUSTOM DOOR TOP SHAPES FOR HOMES REQUIRING A TRULY UNIQUE LOOK.

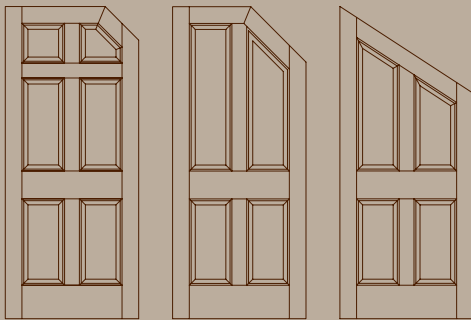

Clipped Corner Doors

To maximize architectural integrity, Captiva MDF Doors are also available with clipped corners for doors that meet an angled ceiling (such as in an attic or under a stair).



Panel options.

Captiva offers a large selection of panel profile options for all of our MDF doors. Each door style is available in the panel options shown. We can also match an existing panel or create a custom design.

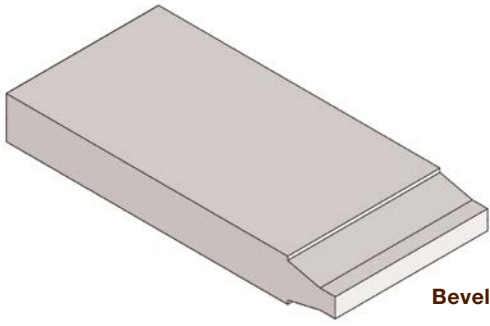

Bevel Panel

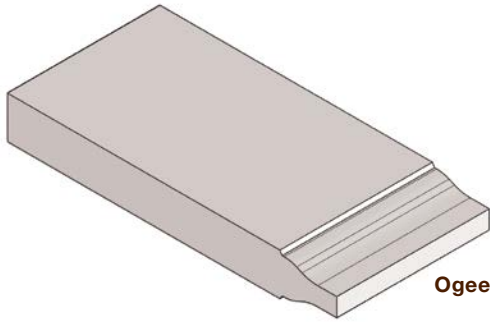

Ogee Panel

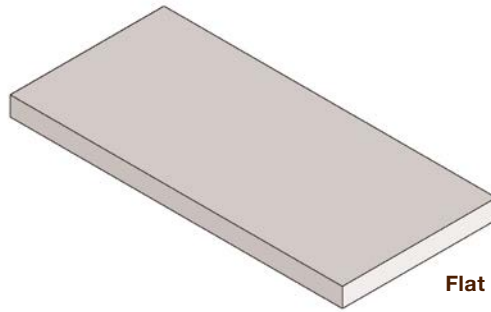

Flat Panel

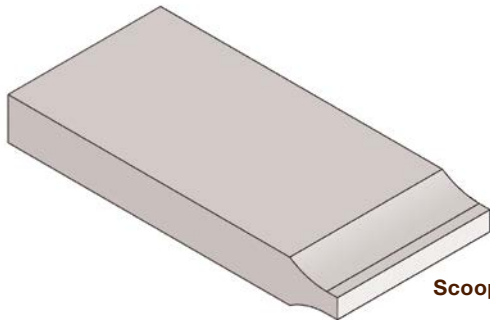

Scoop Panel

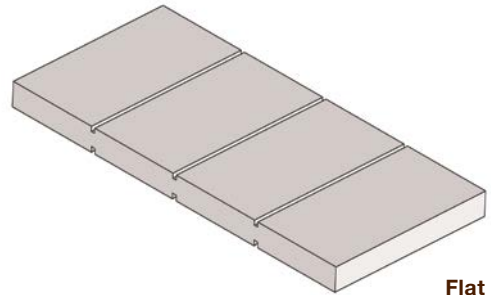

**Flat Panel with 1/8", 1/4"
OR 3/8" Square Groove**

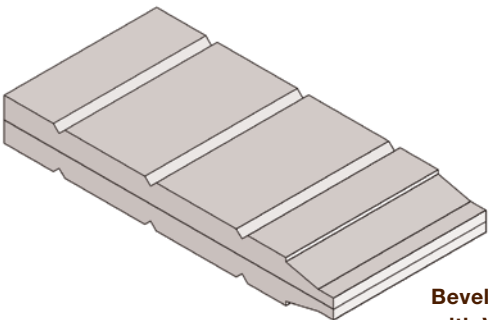

**Bevel Panel
with V-Groove**

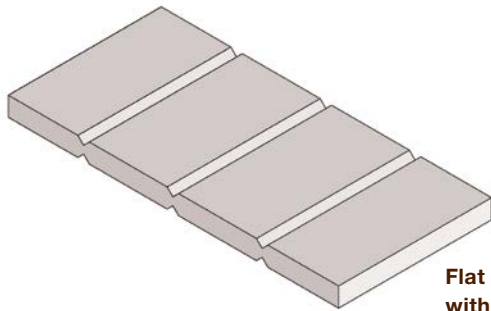

**Flat Panel
with V-Groove**

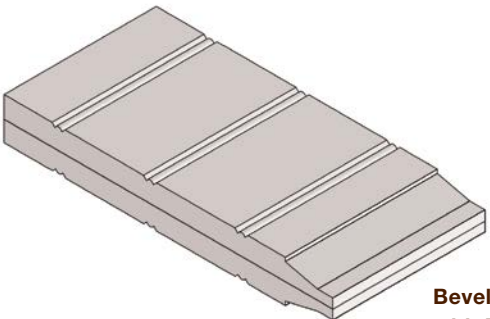

**Bevel Panel
with Bead**

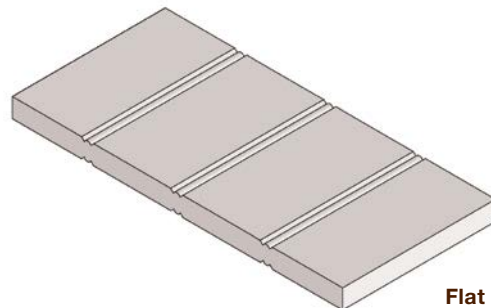

**Flat Panel
with Bead**

Sticking options.

Captiva offers a wide array of sticking profile options for all of our MDF doors. Each door style is available in the sticking options shown or if you are looking for something custom, we can build it. For Applied and Bolection sticking, wood moulding is used for durability.

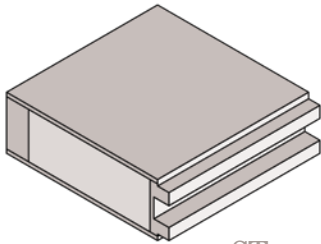

ST
Step

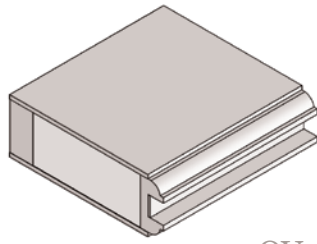

OV
Ovolo

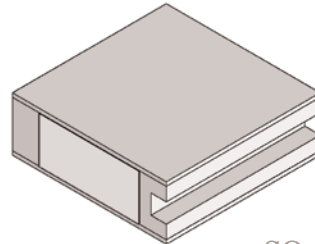

SQ
Square

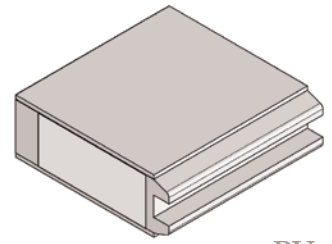

BV
Bevel

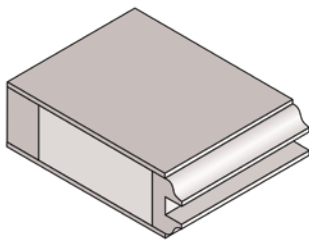

OG
Roman Ogee

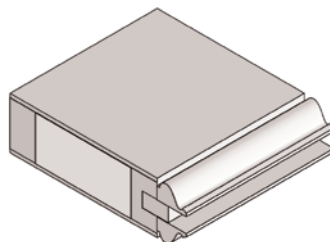

AM
Applied Moulding

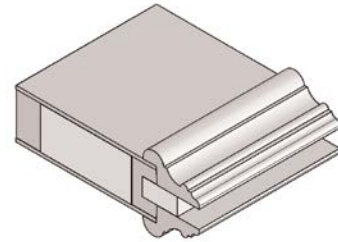

BM
Bolection Moulding

Common panel and sticking combinations:

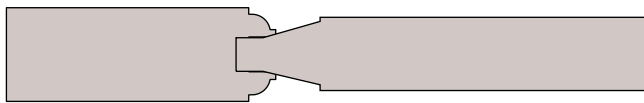

Ovolo Sticking with Bevel Panel



Square Sticking with Flat Panel

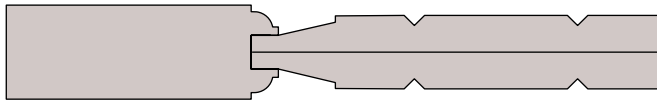

Ovolo Sticking with V-Groove Bevel Panel

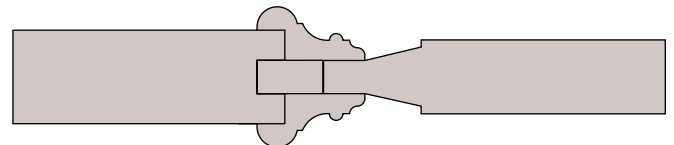

Bolection Moulding Sticking with Bevel Panel

Custom panel or sticking.

If you do not see a panel or sticking option that meets your requirements, send us a sketch and we will match it.



Panel doors.

THE CLASSIC PANEL DOOR. WITH OVER ONE HUNDRED PANEL DOOR DESIGNS TO CHOOSE FROM, ALLOW YOUR IMAGINATION TO RUN WILD. IF YOU DON'T SEE THE DESIGN YOU'RE LOOKING FOR, PROVIDE US WITH A DRAWING, PHOTOGRAPH, OR ROUGH SKETCH AND WE WILL CUSTOM DESIGN THE DOOR OF YOUR DREAMS.

Panel door designs.

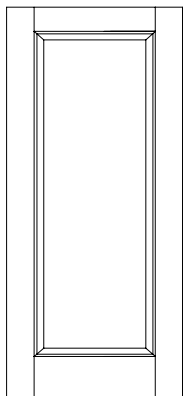

8001

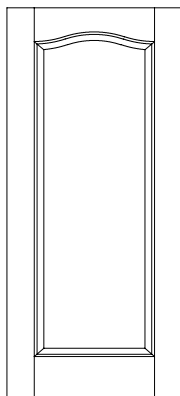

8002

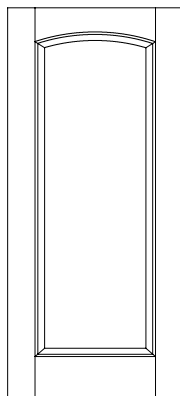

8003

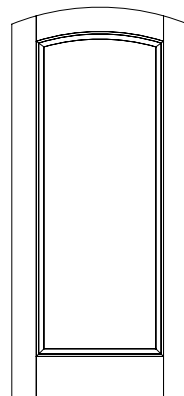

8003A

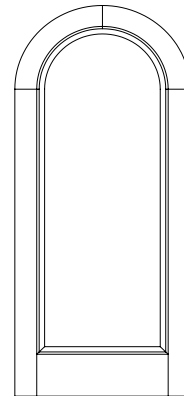

8004R

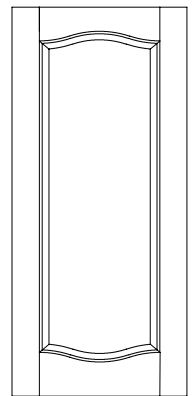

8005

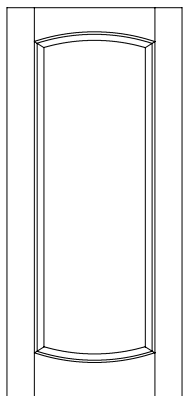

8006

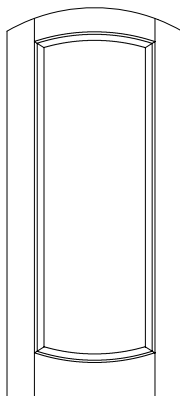

8006A

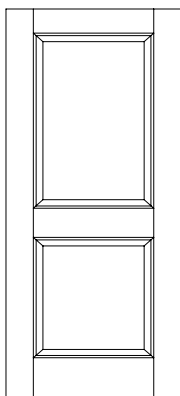

8007

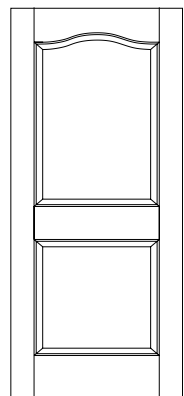

8008

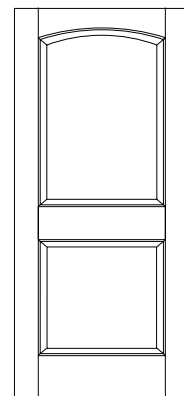

8009

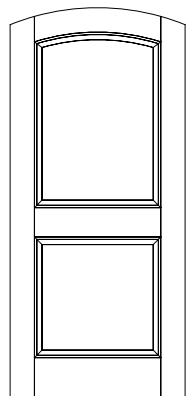

8009A

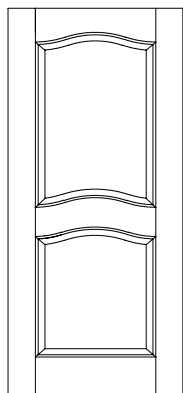

8010

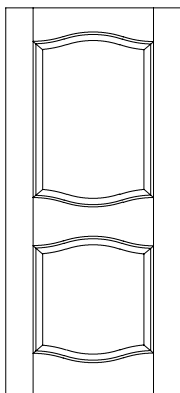

8011

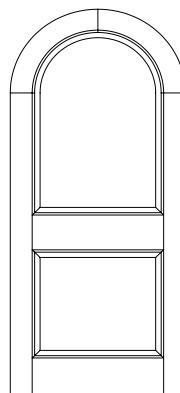

8014R

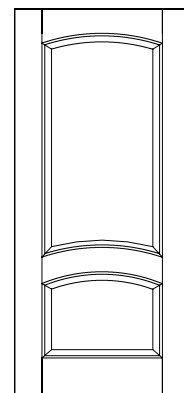

8015

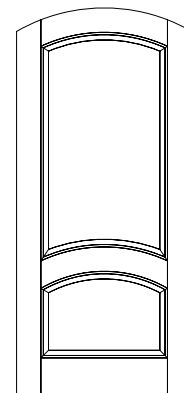

8015A

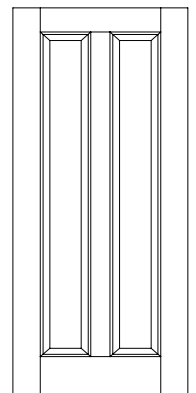

8016

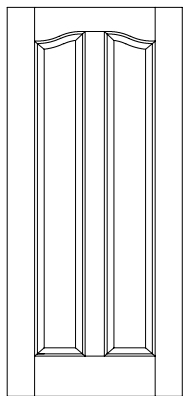

8017 

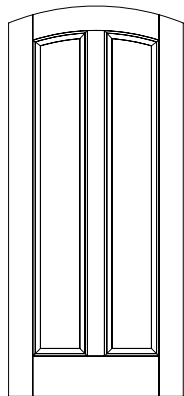

8018A  

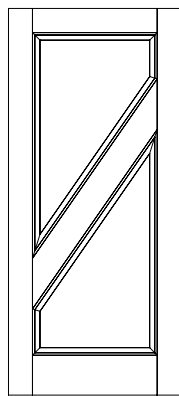

8019

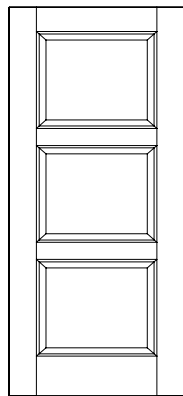

8020

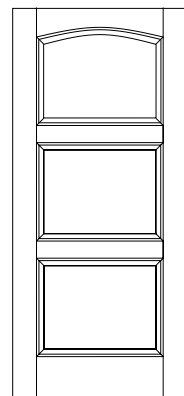

8021  

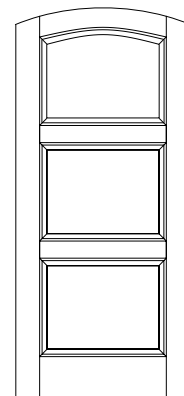

8021A  

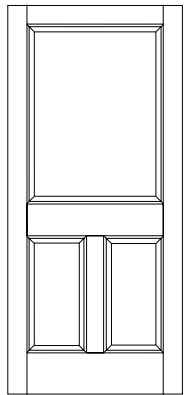

8022

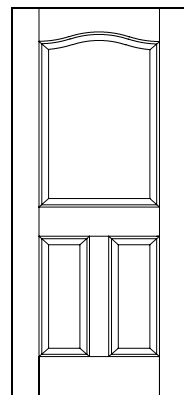

8023 

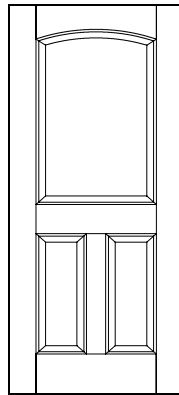

8024  

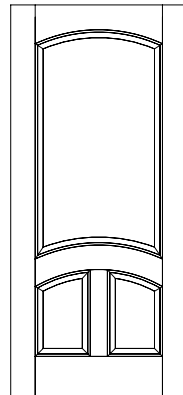

8025  

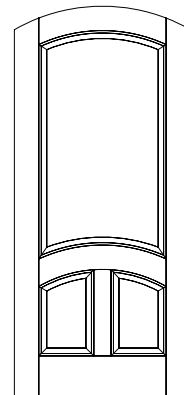

8025A  

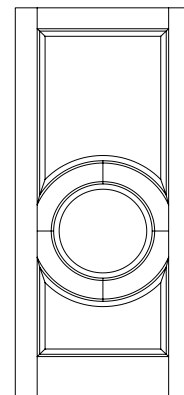

8026

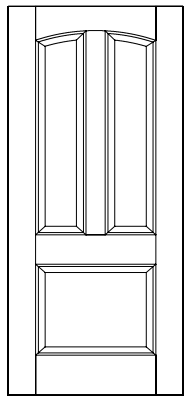

8027  

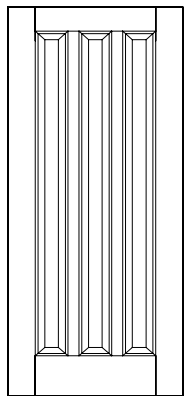

8028

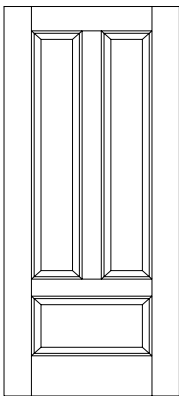

8029

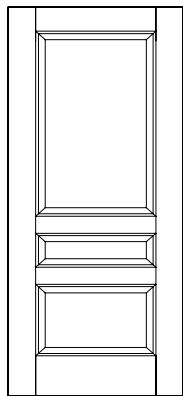

8030

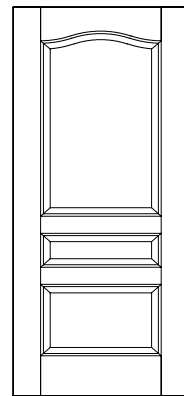

8031 

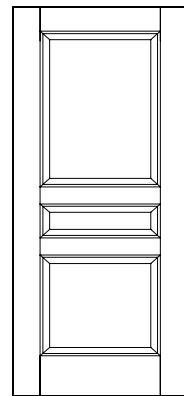

8032

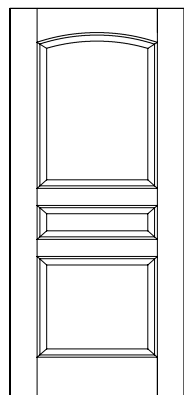

8033  

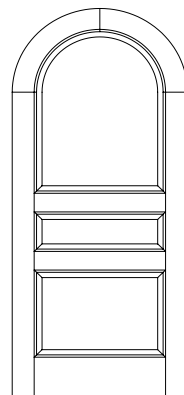

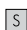
8034R  

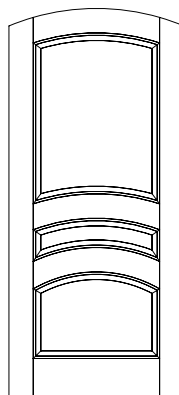

8035A  

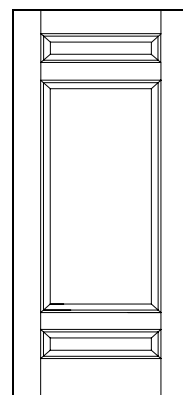

8036

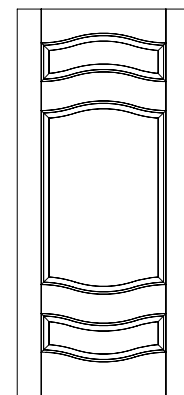

8037 

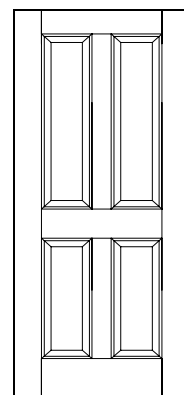

8038

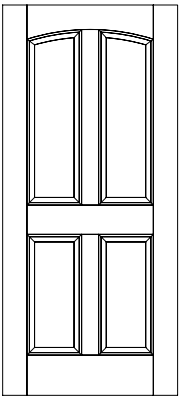

8039  

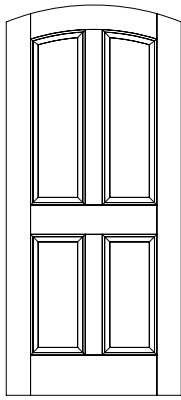

8039A  

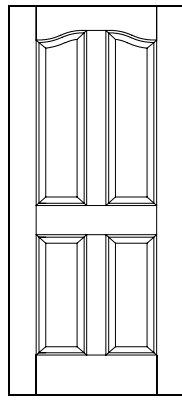

8040 

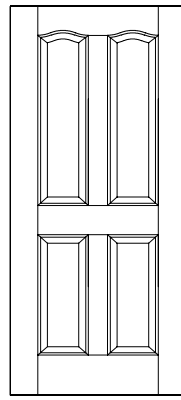

8041

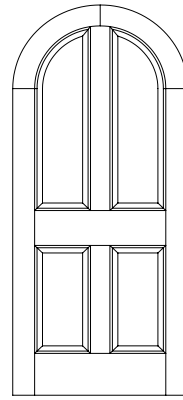

8042R  

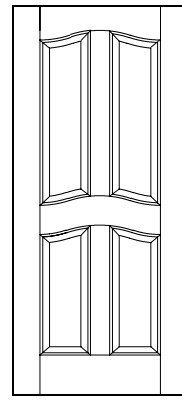

8043 

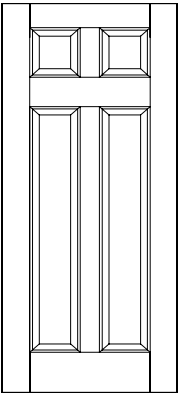

8044

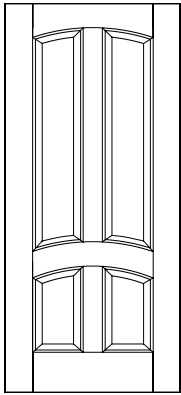

8045  

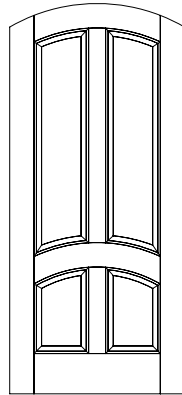

8045A  

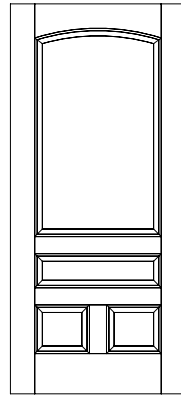

8046  

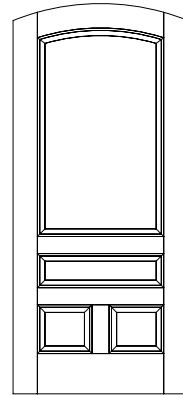

8046A  

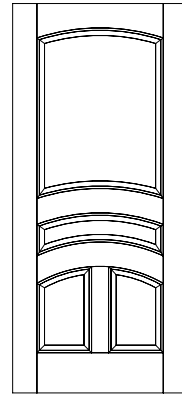

8047  

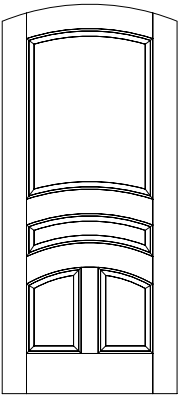

8047A  

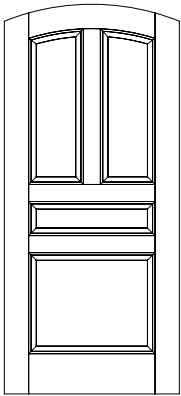

8048A  

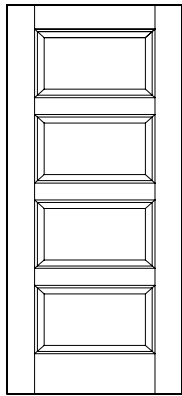

8049

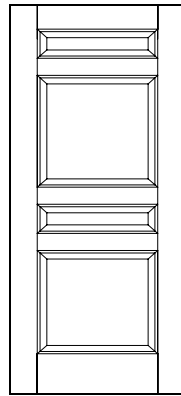

8050

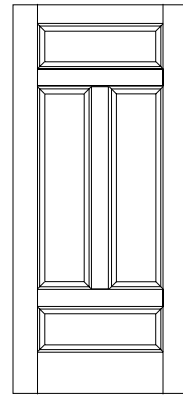

8051

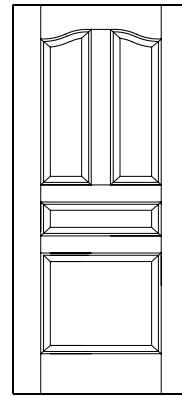

8052 

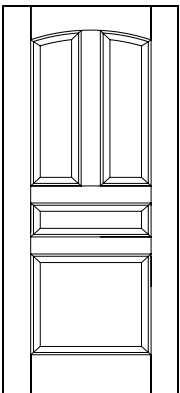

8053  

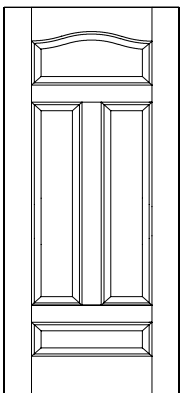

8054 

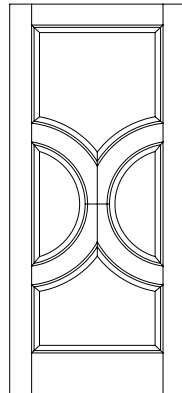

8056

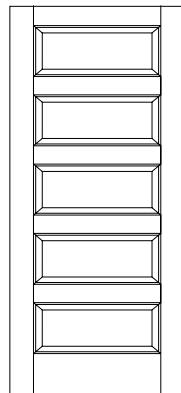

8057

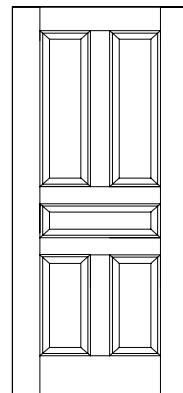

8058

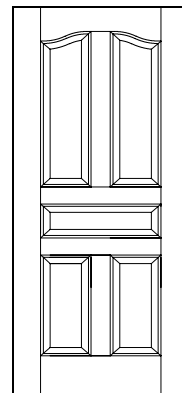

8059 

 Square Top available  Arched Top available  Round Top available

 Double Door Arched Pair available, see pages 22-23

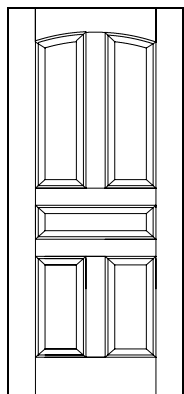

8060  

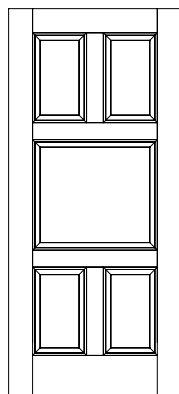

8061

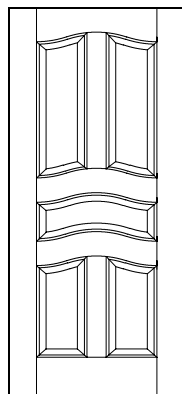

8062 

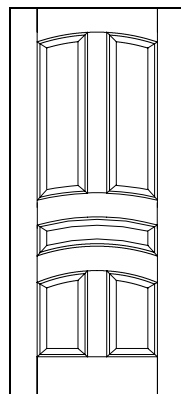

8063  

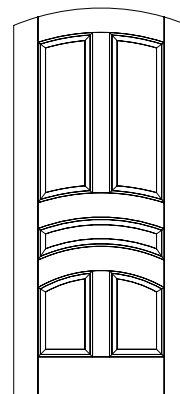

8063A  

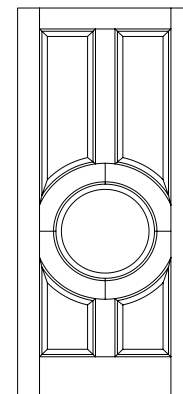

8064

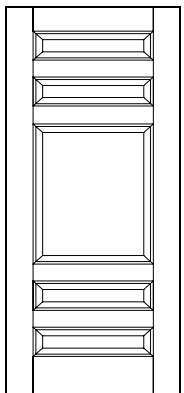

8065

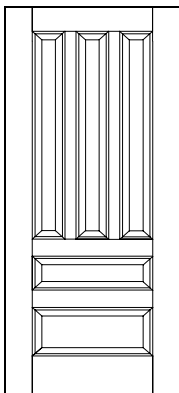

8066

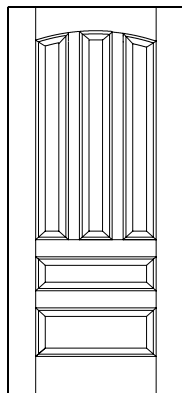

8067  

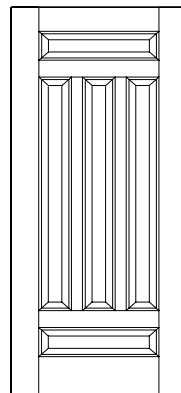

8068

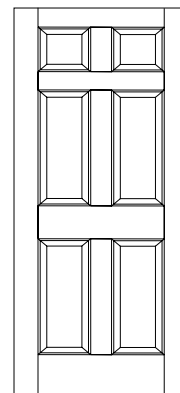

8069

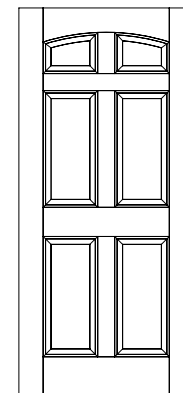

8070  

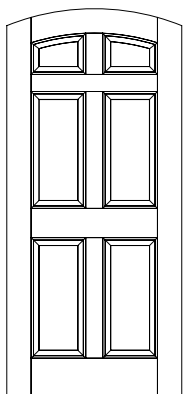

8070A  

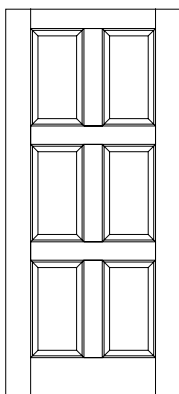

8071

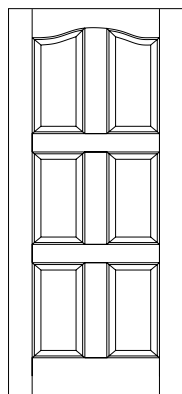

8072 

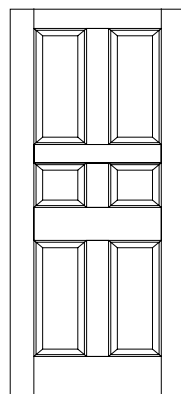

8073

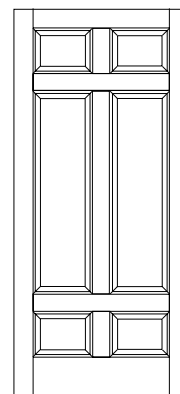

8074

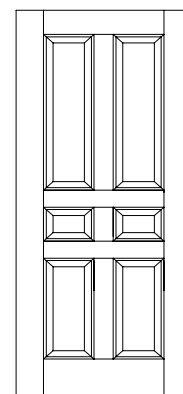

8075

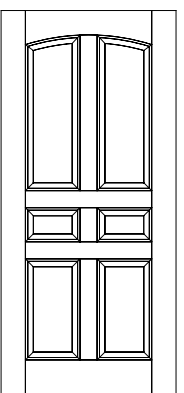

8076  

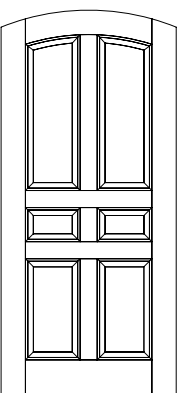

8076A  

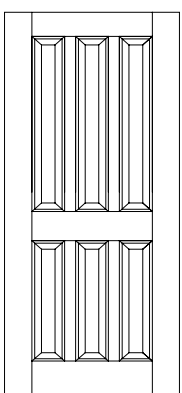

8077

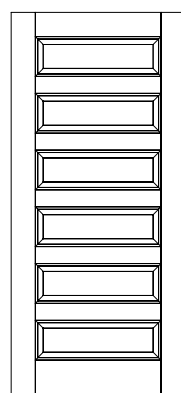

8078

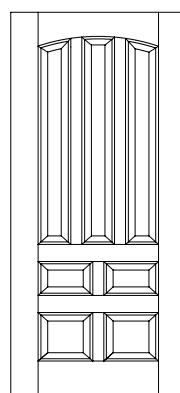

8079  

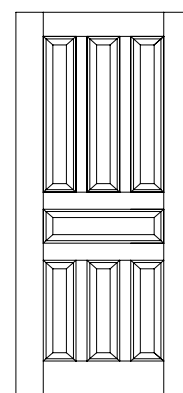

8080

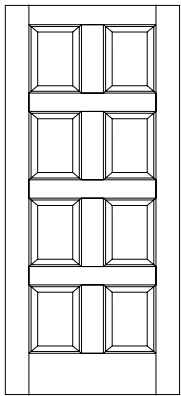

8081

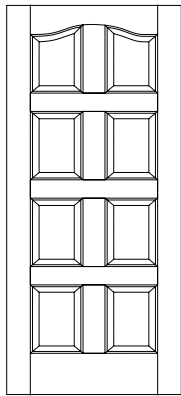

8082

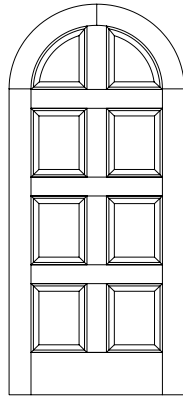

8083R

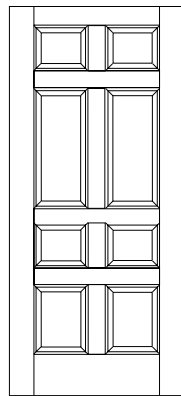

8084

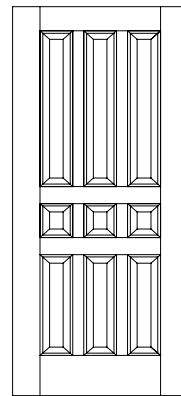

8085

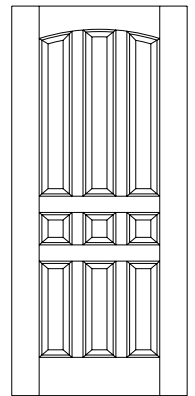

8086

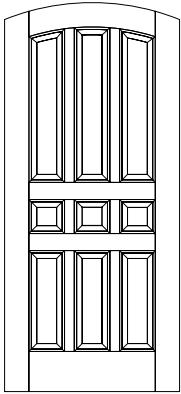

8086A

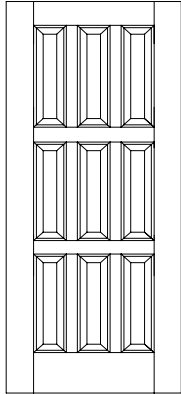

8087

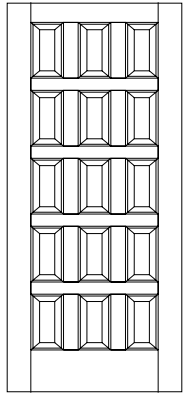

8088

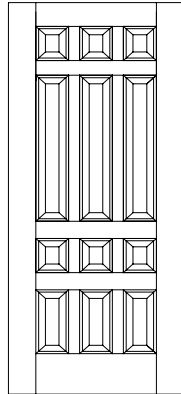

8089

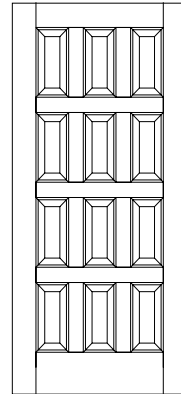

8090

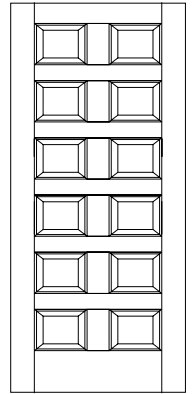

8091



CAPTIVA

Louver doors.

Available with square sticking only.

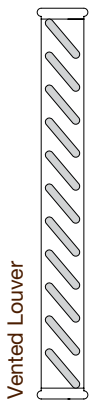

Vented Louver

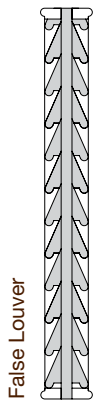

False Louver

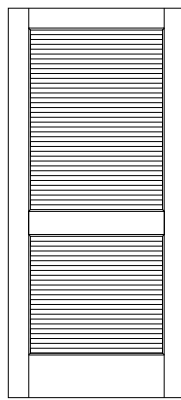

8140

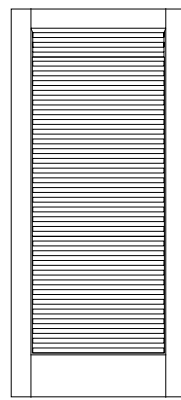

8141

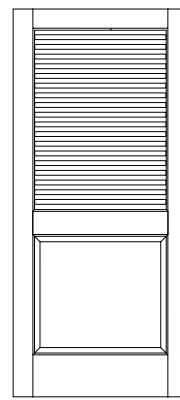

8142

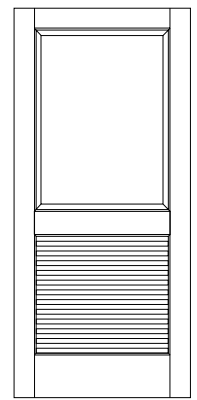

8143

Square Top available

Arched Top available

Round Top available

Double Door Arched Pair available, see pages 22-23



Glass doors.

Single Pane Glass

Suggested for interior use only, our 1/8" single strength tempered glass is available for all our glass door designs (see opposite page for details and availability).

Insulated Glass

We use 5/8" tempered insulated glass with optional LoE and/or argon gas. (see opposite page for details and availability).

Muntin Bars

With three profiles to choose from — Ovolo, Square, Bevel, and Step — muntin bars typically match the door's sticking (see opposite page for details and availability).

Decorative Glass

When your project requires a special order decorative glass, provide us with a sketch, picture, or idea and we will call on our glass suppliers from around the country to find the particular glass that you desire.



CAPTIVA

Glass options.

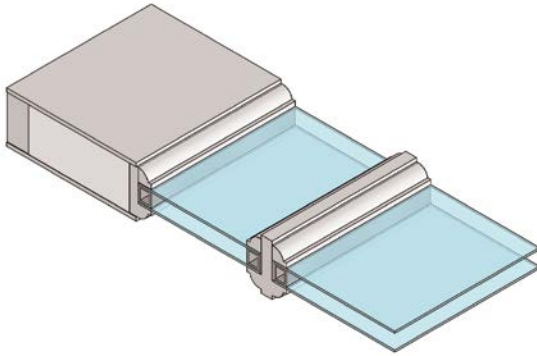

Insulated Glass
True Divided Lite (TDL)

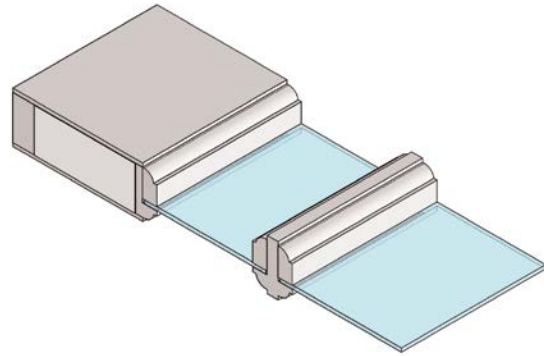

Single Pane Glass
True Divided Lite (TDL)

Muntin bar options and availability.

	1-3/8"	1-1/8"	1"	7/8"
Ovolo Sticking				
Square Sticking				
Bevel Sticking				
Step Sticking				
	<i>Above shown with Insulated Glass and True Divided Lite</i>	<i>Above shown with Insulated Glass and True Divided Lite</i>	<i>Above shown with Insulated Glass and True Divided Lite</i>	<i>Above shown with Single Pane Glass and True Divided Lite</i>

	Door Thickness	1-3/4" Doors				2-1/4" Doors				1-3/8" Doors			
	Muntin Bar Width	1-3/8"	1-1/8"	1"	7/8"	1-3/8"	1-1/8"	1"	7/8"	1-3/8"	1-1/8"	1"	7/8"
Captiva MDF Doors													
True Divided Lite with Insulated Glass		OBS	OBST	OBST		OBS	OBST	OBST		S	OST	OST	
True Divided Lite with Single Pane Glass		OBS	OBST	OBST		OBS	OBST	OBST		S	OST	OST	S

O = Ovolo Sticking, B = Bevel Sticking, S = Square Sticking, T = Step Sticking

Specialty glass options.



SPECIALTY GLASS CAN PROVIDE PRIVACY, FILTER LIGHT OR SIMPLY MAKE A DRAMATIC STATEMENT. BELOW ARE SOME OF THE MOST POPULAR STYLES OF SPECIALTY GLASS FROM ARCHITECTURAL GLASS EFFECTS. FROM TRADITIONAL TO MODERN, OUR GLASS SUPPLIERS HAVE HUNDREDS OF STYLES TO MEET YOUR NEEDS.



Frosted

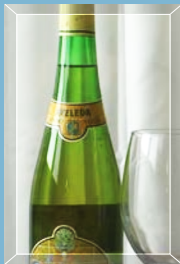

Bevel



Bark



Chinchilla



Ribbed



Everglade



Reeded



Stipplite



Crepe



Eng Flemish



Glue Chip



Double Chip



Wind



Mirage



Cobblestone



Linen



Water



Imported Seedy



Drift



Matrix



Bamboo



Luster



Aqui



Confetti

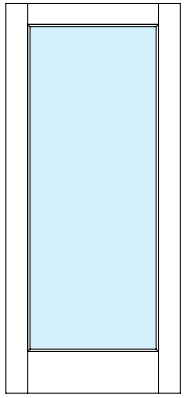

8601

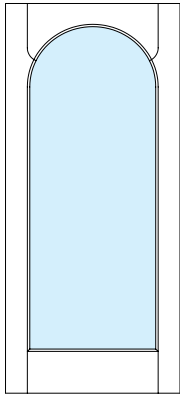

8602  

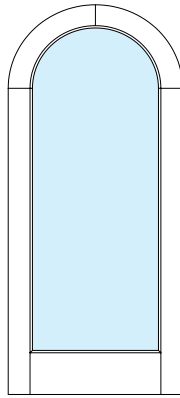

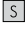
8602R  

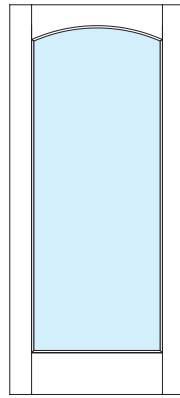

8603  

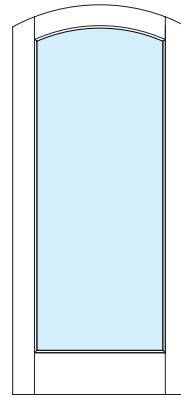

8603A  

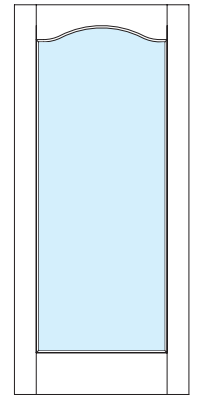

8604 

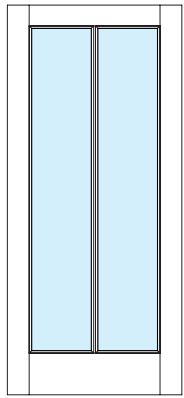

8605

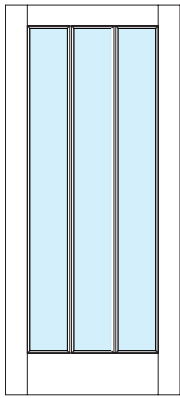

8606

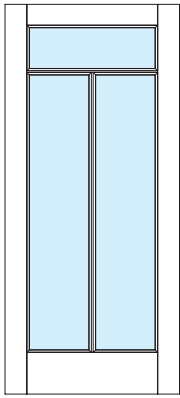

8607

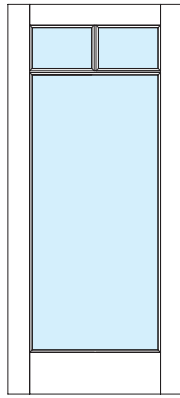

8608

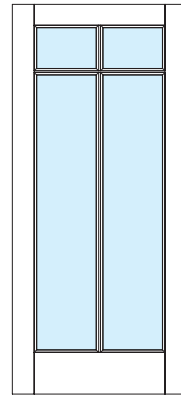

8609

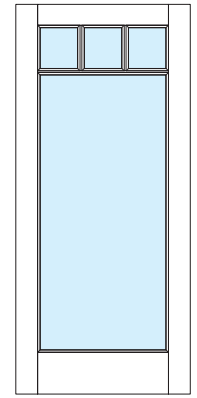

8610

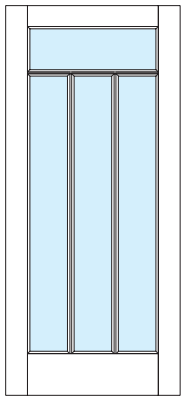

8611

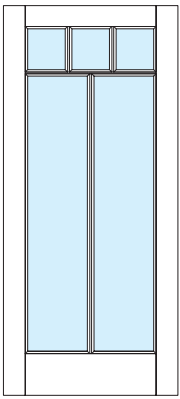

8612

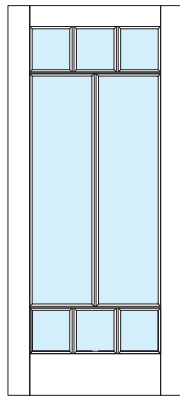

8613

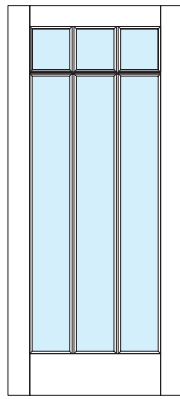

8614

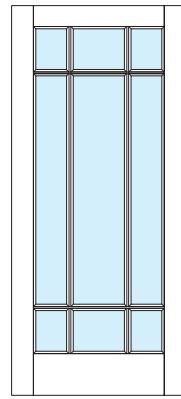

8615

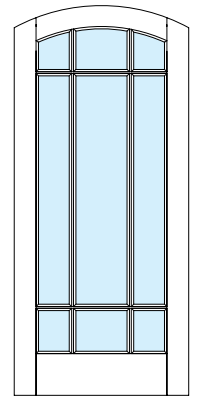

8616A  

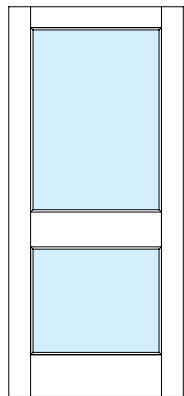

8617

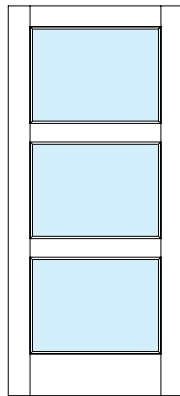

8618

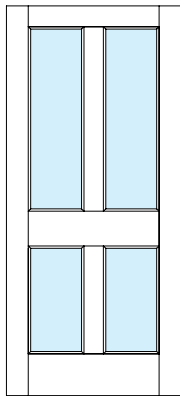

8619

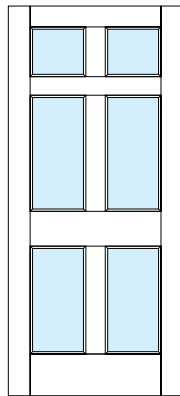

8620

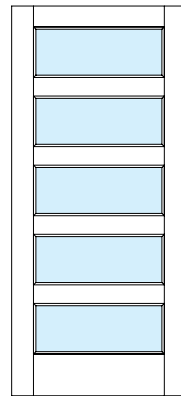

8621

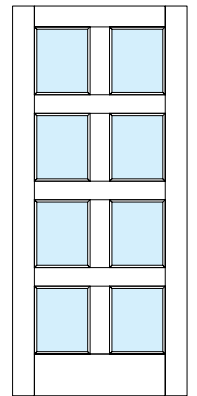

8622

 Square Top available

 Arched Top available

 Round Top available

*Not available with SDL internal spacer.

 Double Door Arched Pair available, see pages 22-23

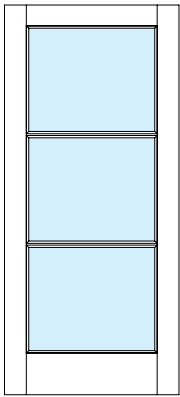

8623

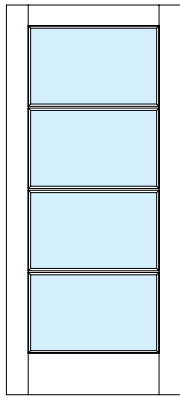

8624

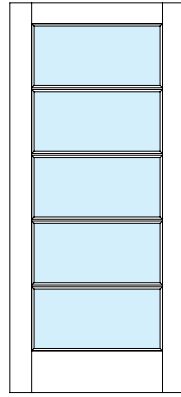

8625

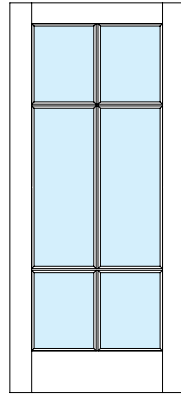

8626

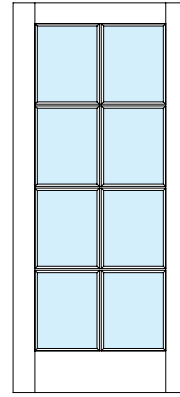

8627

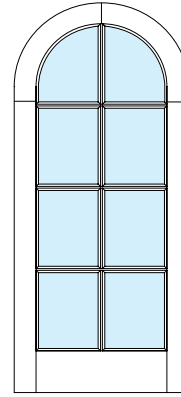

8628R  

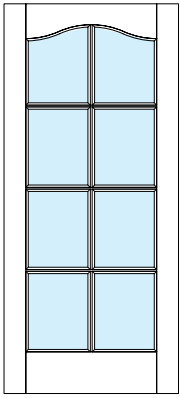

8629 

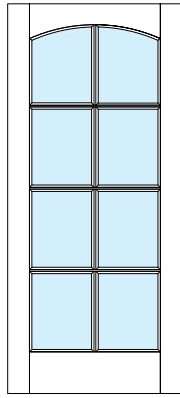

8630  

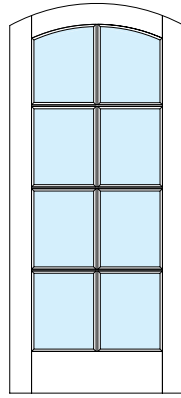

8630A  

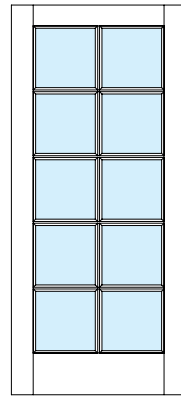

8631

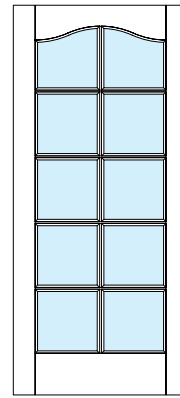

8632 

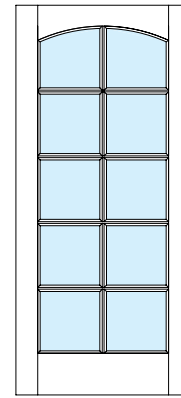

8633  

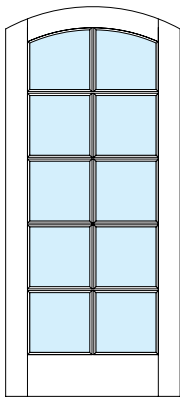

8633A  

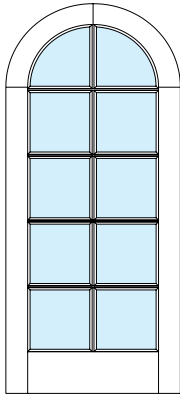

8634R  

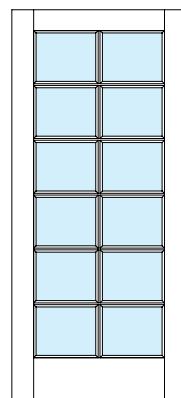

8635

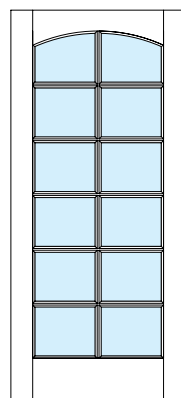

8636  

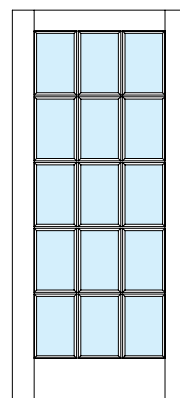

8637

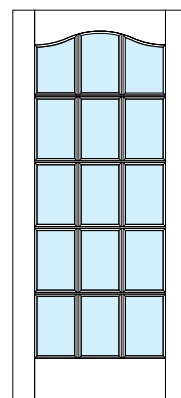

8638 

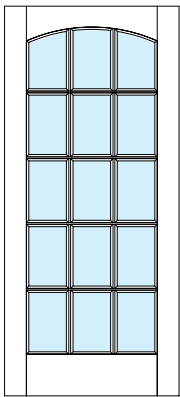

8639  

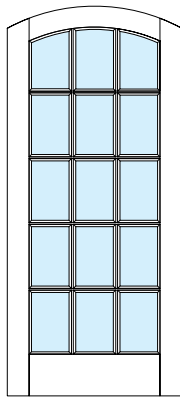

8639A  

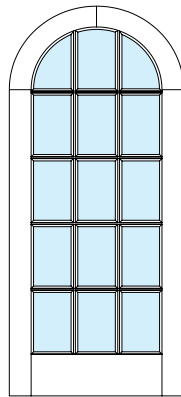

8640R  

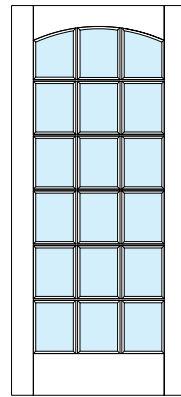

8641  

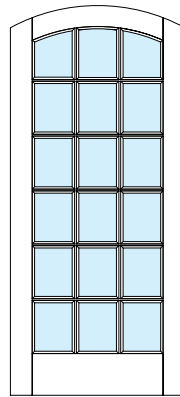

8641A  

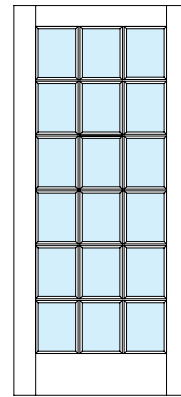

8642

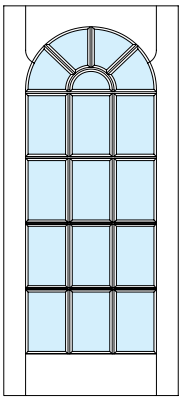

8643* R

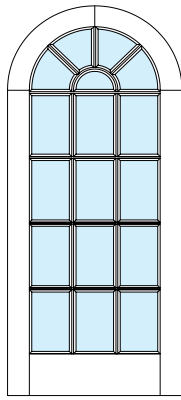

8643R* S DD

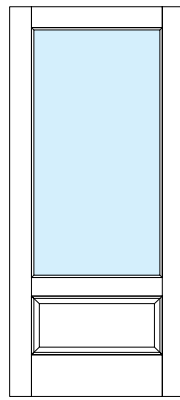

8301

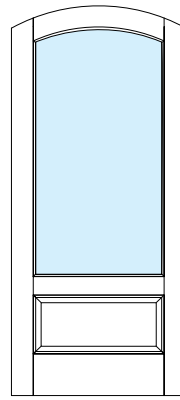

8302A S DD

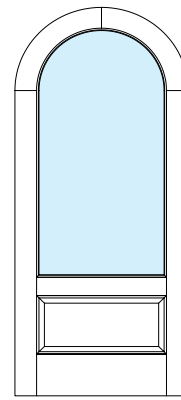

8303R S DD

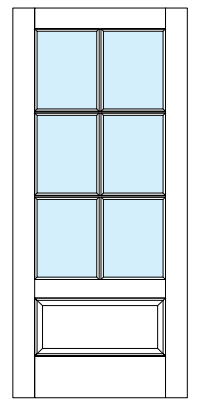

8304

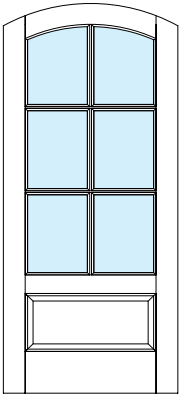

8305A S DD

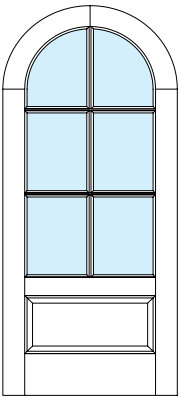

8306R S DD

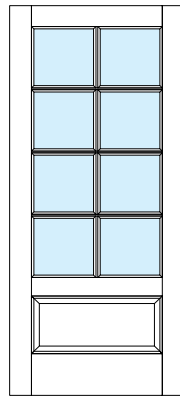

8307

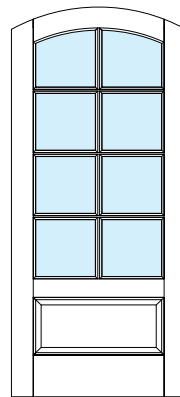

8308A S DD

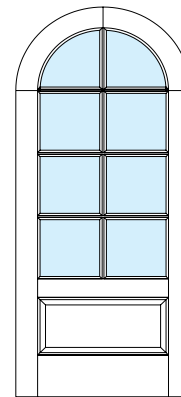

8309R S DD

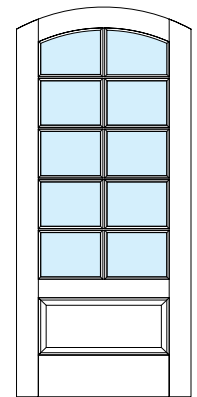

8310A S DD

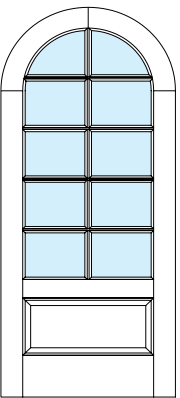

8311R S DD

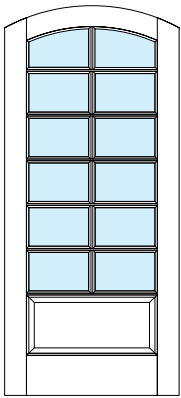

8312A S DD

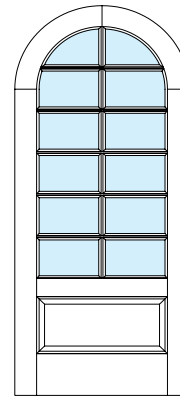

8313R S DD

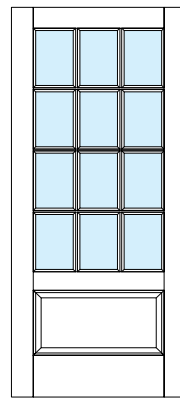

8314

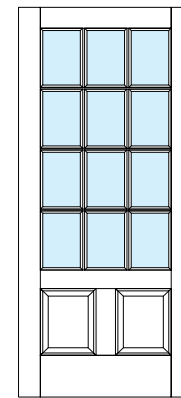

8315

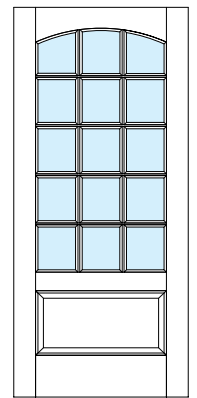

8316 A DD

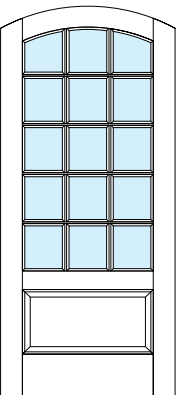

8316A S DD

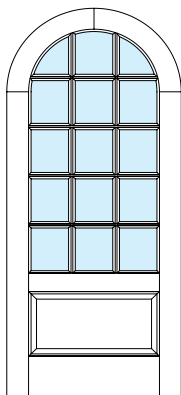

8317R S DD

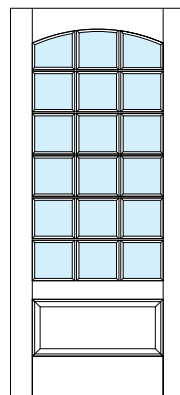

8318 A DD

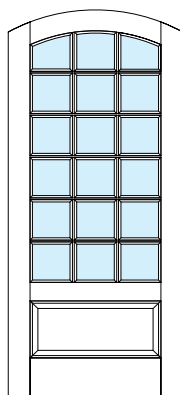

8318A S DD

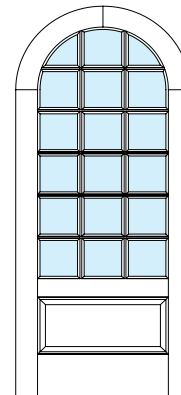

8319R S DD

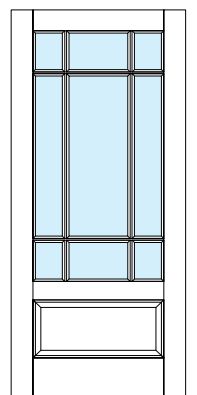

8320

S Square Top available

A Arched Top available

R Round Top available

*Not available with SDL internal spacer.

DD Double Door Arched Pair available, see pages 22-23

Double door arched pairs.



Custom Arched Pair, Beaded, Painted

 Look for this symbol below the door designs throughout this catalog to know which doors are available as a double door arched pair.

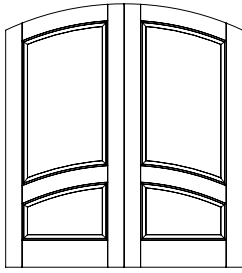

8015AP

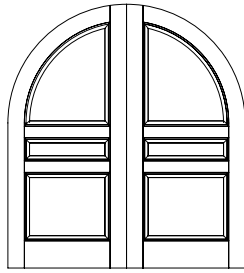

8034RP

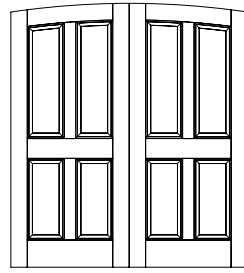

8039AP

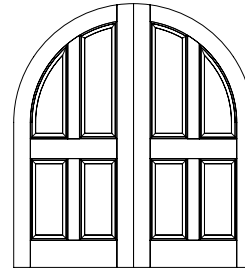

8042RP

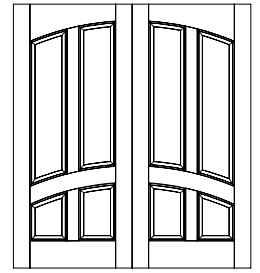

8045P

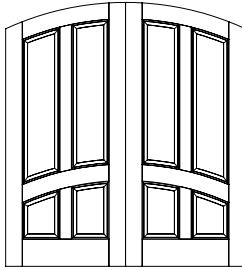

8045AP

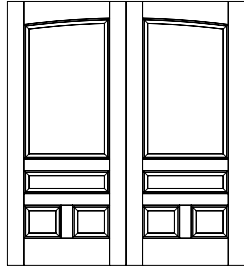

8046P

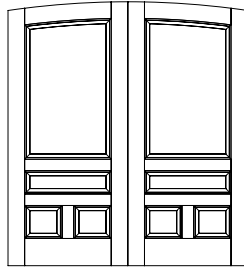

8046AP

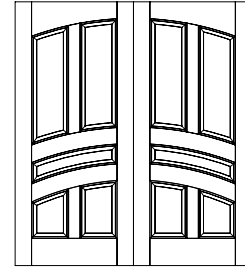

8063P

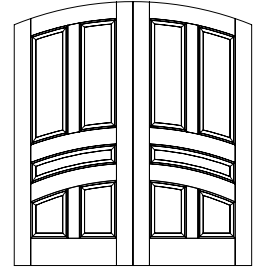

8063AP

Panel Doors

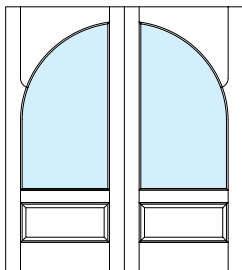

8303P

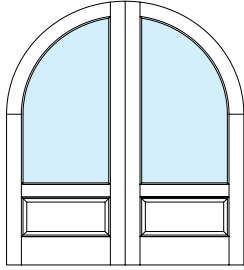

8303RP

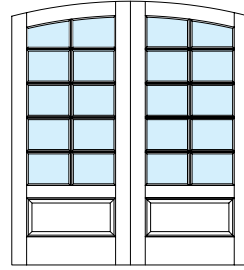

8310AP

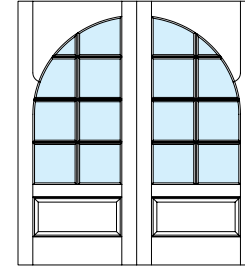

8309P

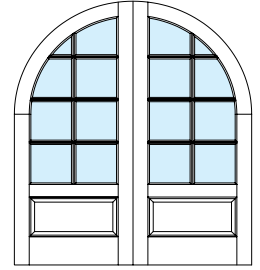

8309RP

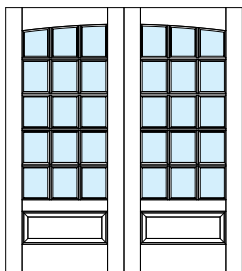

8316P

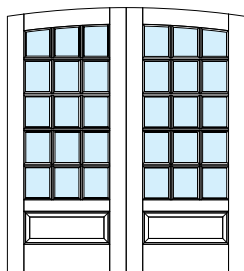

8316AP

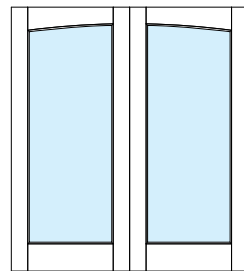

8603P

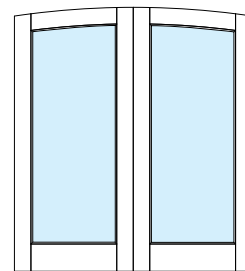

8603AP

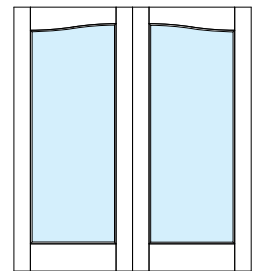

8604P

Glass Doors

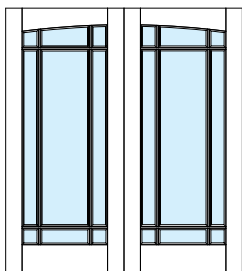

8616P

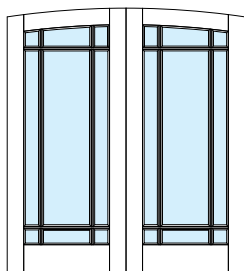

8616AP

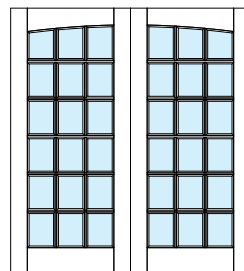

8641P

P = Pair AP = Arched Pair RP = Round Pair

Modern door designs.



The following designs are only available in Square Groove. See page 26 for detailed image. Most grooved patterns will utilize 1/4" MDF veneers with 1/8" deep grooves. Stile and rail construction unless otherwise noted as Flush (F).

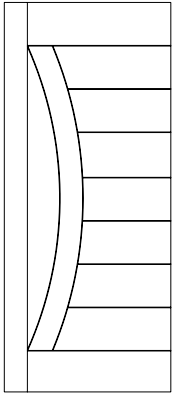

8093 F

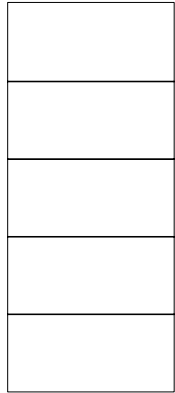

8094 F

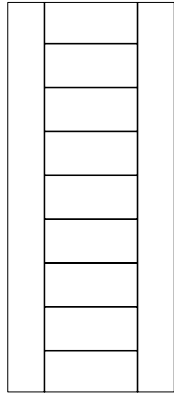

8095 F



8096 F

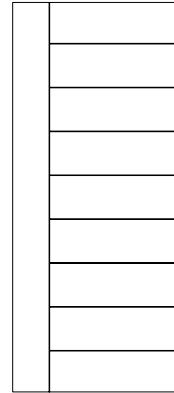

8097 F

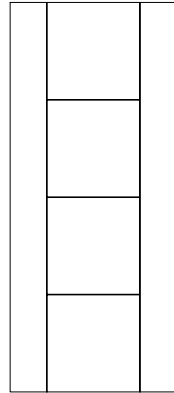

8098 F

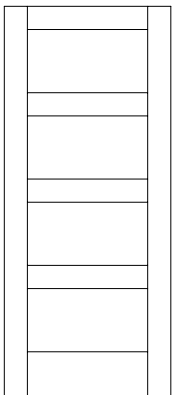

8122

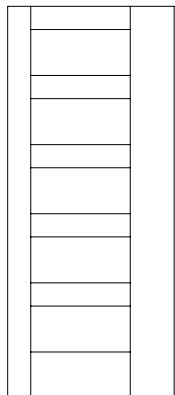

8123

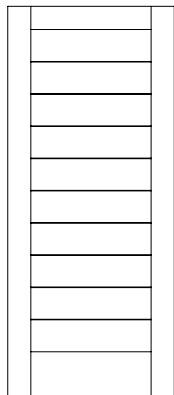

8124

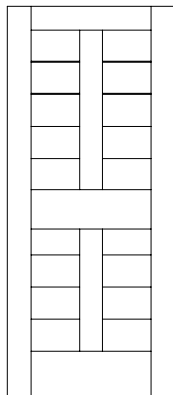

8125

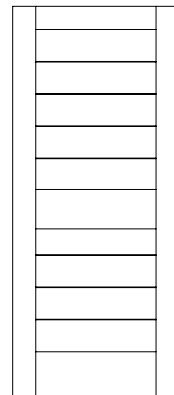

8126

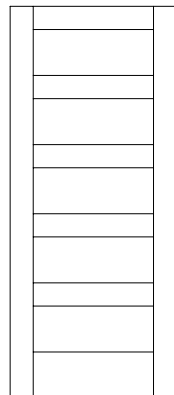

8127

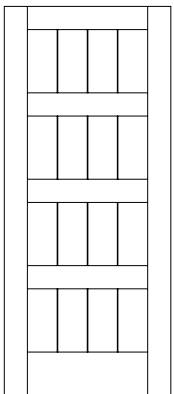

8128

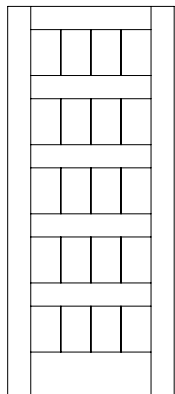

8129

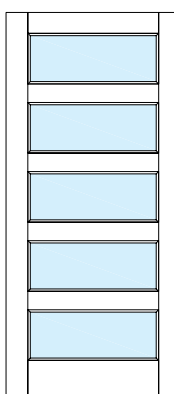

8443

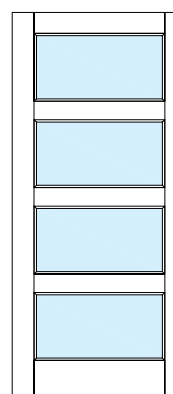

8444

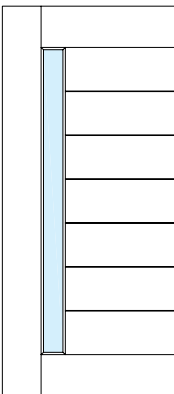

8402 F

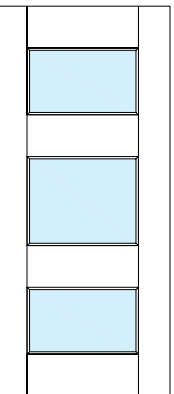

8403

F - Flush construction

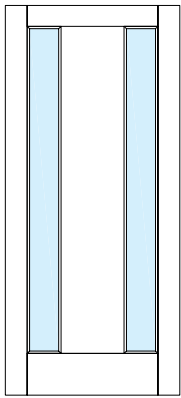

8398

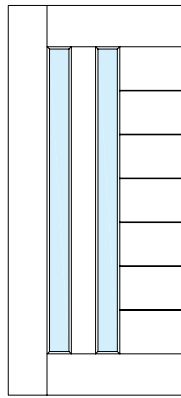

8399 *F*

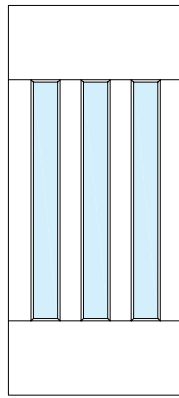

8400 *F*

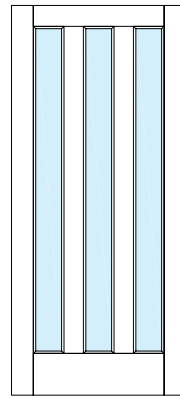

8401

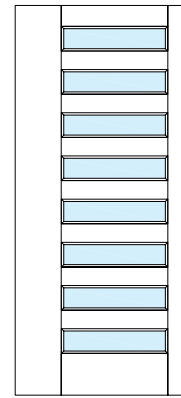

8405

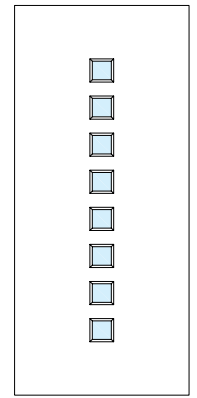

8409 *F*

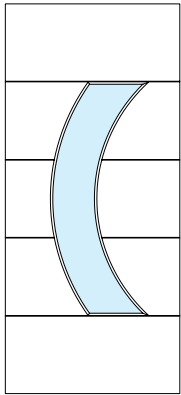

8410 *F*

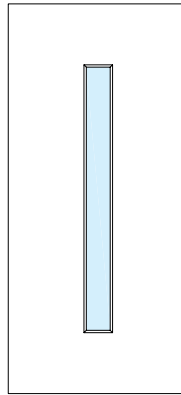

8411 *F*

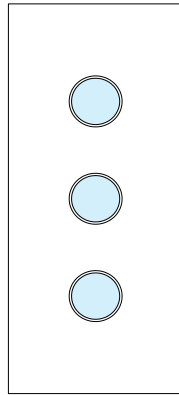

8412 *F*

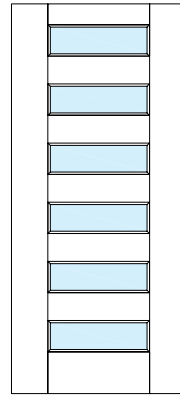

8413

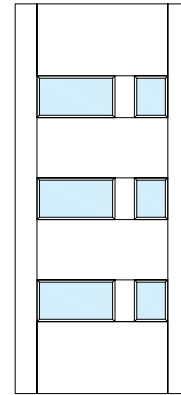

8414

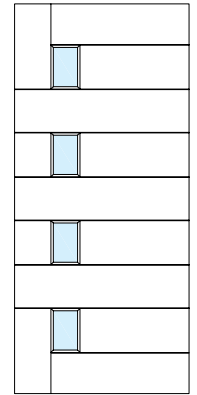

8415 *F*

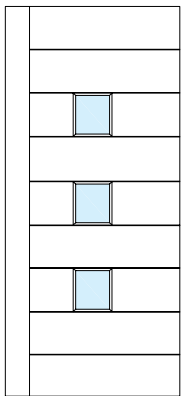

8416 *F*

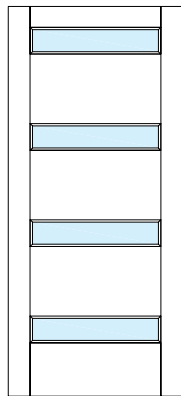

8417

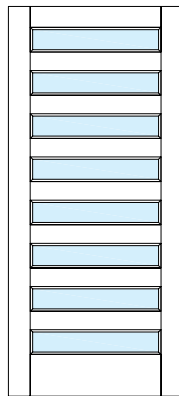

8418

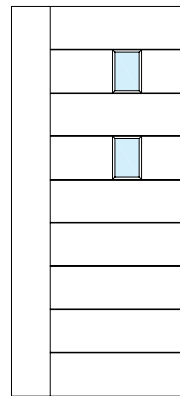

8419 *F*

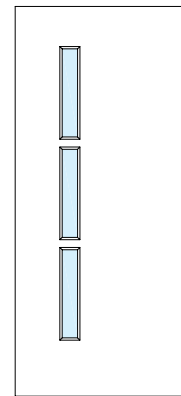

8421 *F*

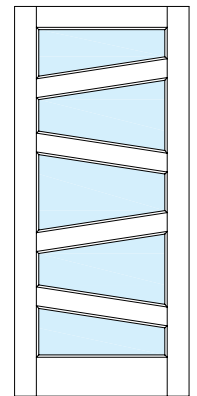

8424

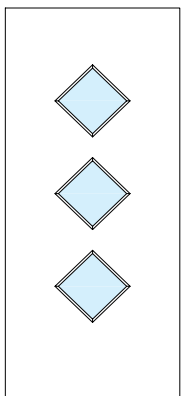

8425 *F*

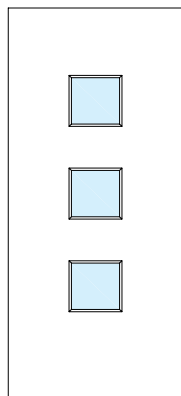

8426 *F*

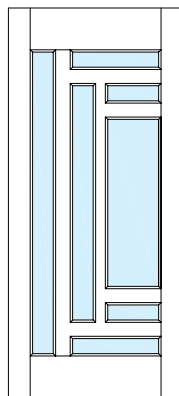

8428

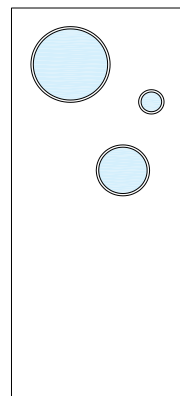

8429 *F*

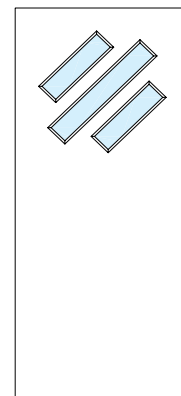

8432 *F*

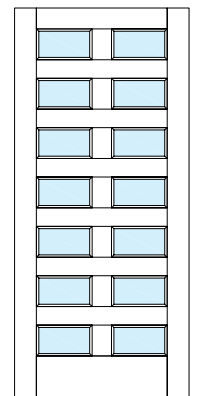

8433

F - Flush construction

Specialty doors.



CAPTIVA CUSTOM MDF DOORS ALLOW ENDLESS OPTIONS FOR YOUR DESIGN. WE OFFER PLANK DOORS, DUTCH DOORS, BARN DOORS, FIRE-RATED DOORS AND TRANSOMS TO ENSURE YOUR ENTIRE PROJECT MATCHES SEAMLESSLY.

Grooved doors.

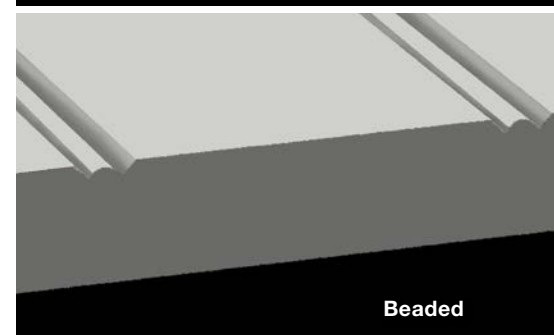
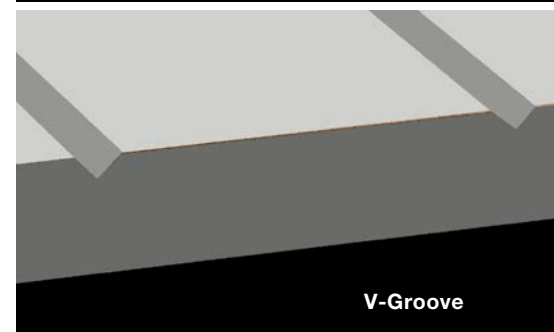
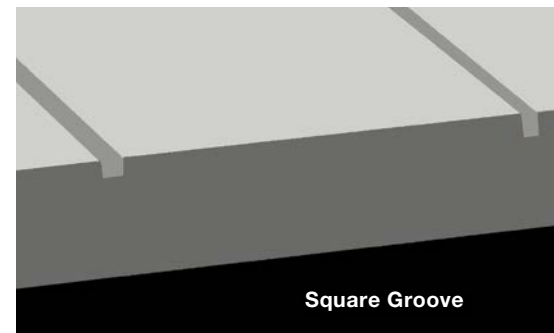

Grooved and Beaded

Add farmhouse style to your door with our Square Groove, V-Groove or Beaded panel option. The panels of any door that we offer can be carved with this decorative option. See the opposite page for a handful of door designs that are commonly given Square Groove, V-Groove or Beaded panels.

Ordering information

When specifying Square Groove, V-Groove or Beaded Panels, use the letter "S" after the door style number for Square Groove, the letter "V" after the door style number for V-Groove panels and the letter "B" after the door style number for Beaded Panels.

Grooved door designs.

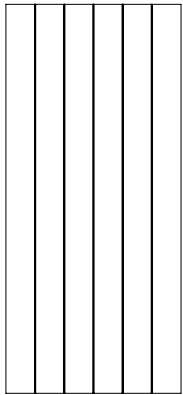

8150S/V/B *F*

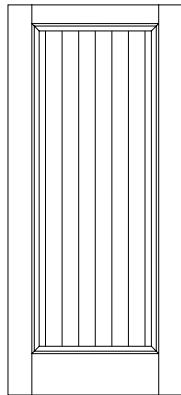

8001S/V/B

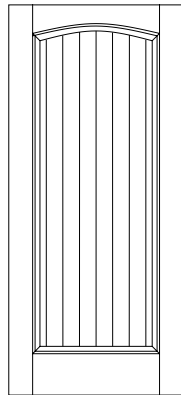

8003S/V/B *A*

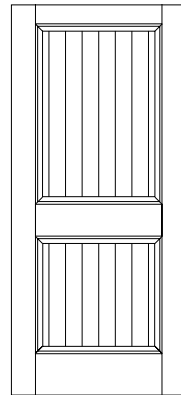

8007S/V/B

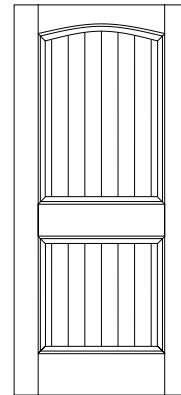

8009S/V/B *A*

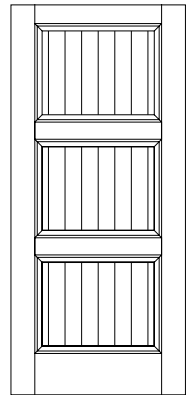

8020S/V/B

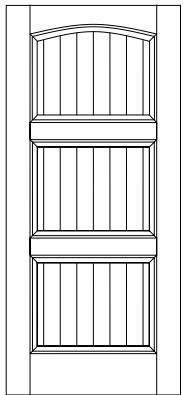

8021S/V/B *A*

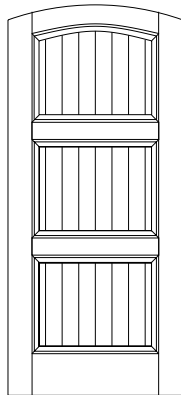

8021AS/V/B *S*

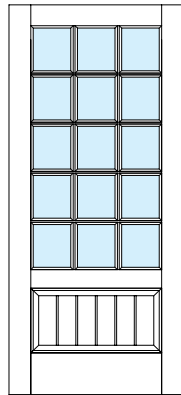

8314S/V/B

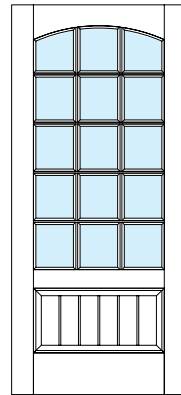

8316S/V/B *A*

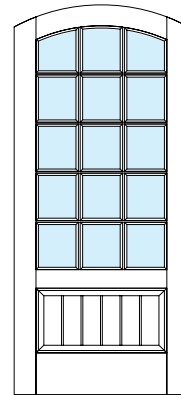

8316AS/V/B *S*

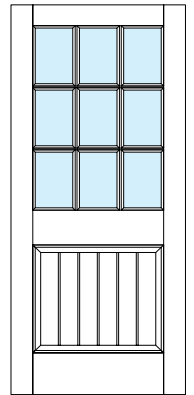

8333S/V/B

Dutch doors.

CAPTIVA DUTCH DOORS ARE BOTH FUNCTIONAL AND BEAUTIFUL. THEY CAN KEEP CHILDREN AND PETS SAFELY ENCLOSED WHILE LIGHT AND AIR CIRCULATE, AND ADD COLONIAL NEW ENGLAND CHARACTER TO YOUR HOME. WE HAVE ACCESS TO A RANGE OF TRADITIONAL, RUSTIC AND CONTEMPORARY HARDWARE TO COMPLEMENT YOUR STYLE.



Quadrant



Door Bolt

Hardware

Quadrants or door bolts can be used to fasten both the lower and upper leaves of any Dutch door. They are available in a variety of finishes: including black, brass, antique brass, oil rubbed bronze, polished or brushed chrome, satin nickel, and more, to match your handleset and hinges.



Barn doors.

Sliding Doors and Hardware

The following page shows traditional barn door styles; nearly every Captiva door panel in this catalog can be modified for a sliding application.

The designs on page 29 are available in V-Groove or Square Groove. See page 26 for detailed image. Most grooved patterns will utilize 1/4" MDF veneers with 1/8" deep grooves. Stile and rail construction unless otherwise noted as Flush (F). All styles are available as sliding (barn) or swinging use.

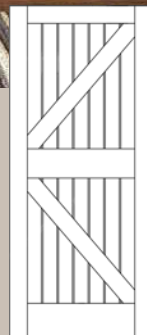

**K-Style
V-Groove
IN STOCK**

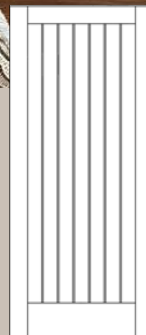

**1 Panel
V-Groove
Quick Ship**

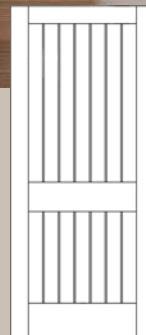

**2 Panel
V-Groove
Quick Ship**

Stock and quick ship barn doors are 3/0 x 7/0 (ideal for openings 28" - 34") and have a pre-routed bottom groove for the floor guide

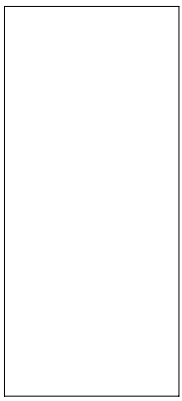

8096

F

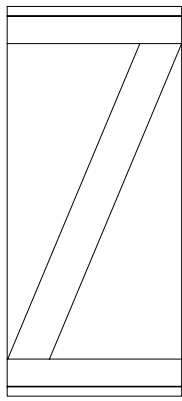

8099

F

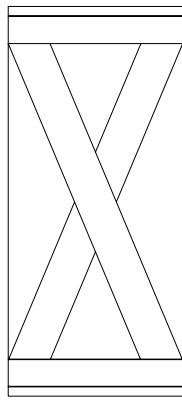

8100

F

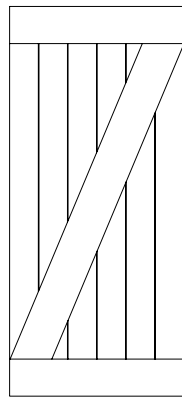

8101

F

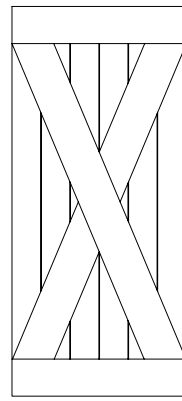

8102

F

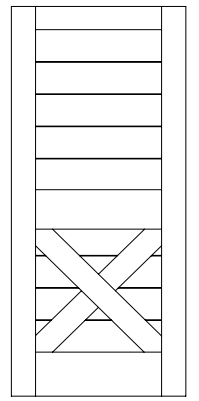

8103

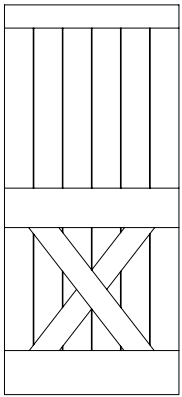

8104

F

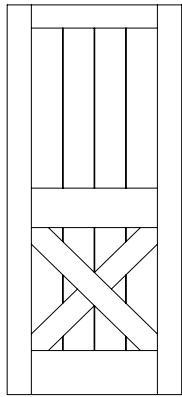

8105

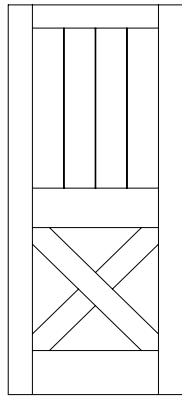

8106

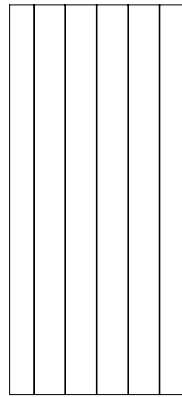

8107

F

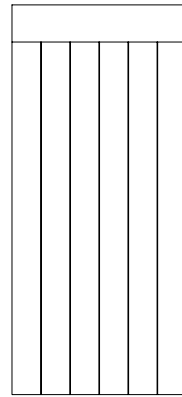

8108

F

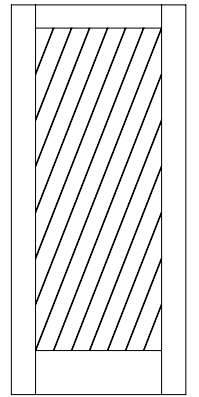

8109

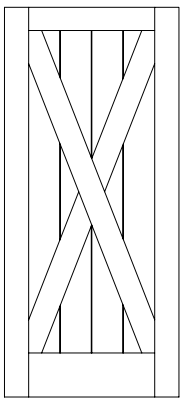

8110

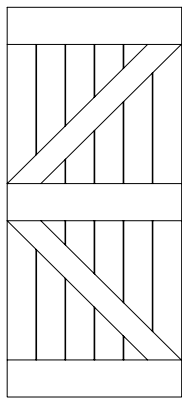

8111

F

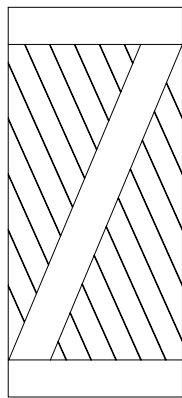

8112

F

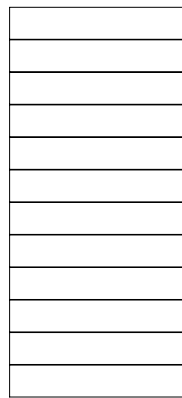

8113

F

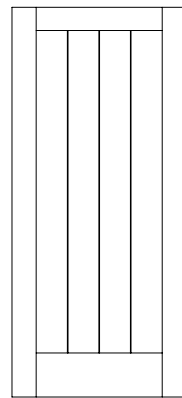

8114

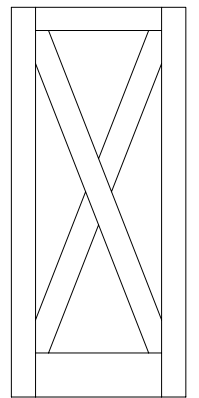

8115

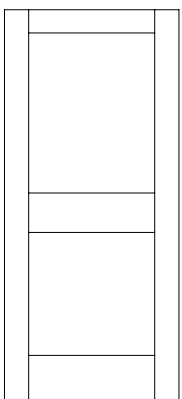

8116

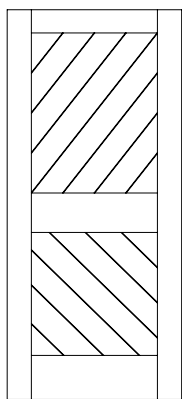

8117

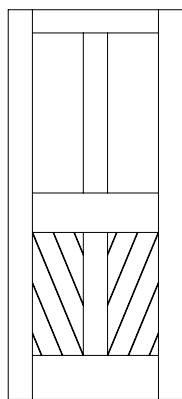

8118

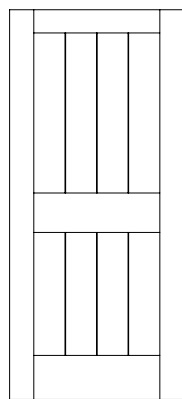

8119

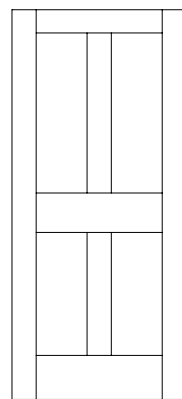

8120

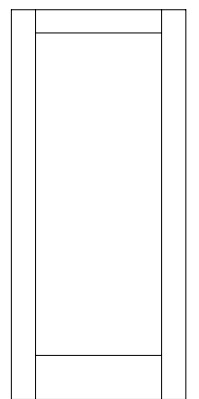

8121

F - Flush construction

Barn door hardware.



Flat Track Hardware,
Powder Coated Black



Hafele Hardware,
Stainless Steel



Pemko Hardware,
Stainless Steel

FLAT TRACK HARDWARE

FLAT TRACK BY LEATHERNECK

Flat Track Hardware styling dates back to the turn of the century when it was used in warehouses and in industrial settings. Flat Track Hardware can be customized for specific applications and can save space while enhancing any door opening.

HÄFELE

HAFELE HARDWARE

Modern stainless steel barn door hardware available for wood barn doors or glass barn doors.



ACME HARDWARE

Acme offers 3 strap hardware styles for barn doors in Stainless Steel, Matt Black and Bronze finishes.



PEMKO HARDWARE

Pemko offers a vast array of sliding door hardware options for many commercial applications.



WOOD TRANSOMS

- Single pane 3/16" annealed glass.
- Simulated divided lite with 1-3/16" muntin bars.
- 4-5/8" clear or primed flat jamb with stop. Will match door unit.
- Standard transom is 13-1/2" height, other sizes available special order.
- Includes trim to match door unit.

SIMULATED DIVIDED LITE TRANSOMS WITH WIDE STILES

- Transom includes wide wood stiles.
- Single pane 3/16" annealed glass.
- Simulated divided lite with 1-3/16" muntin bars.
- 4-5/8" clear or primed flat jamb with stop.
- Standard transom is 13-1/2" height, other heights are available.

Rectangular Transoms

For transoms with grilles, please specify grille pattern.

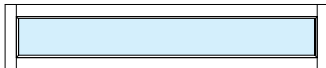

8751

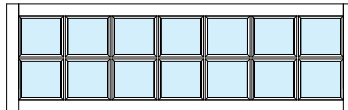

8755

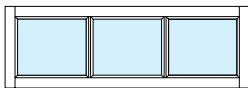

8763

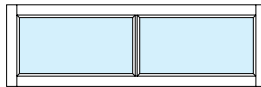

8767

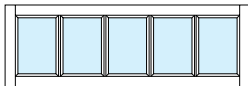

8764

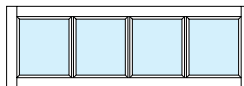

8765

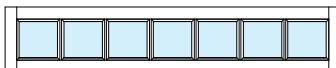

8754

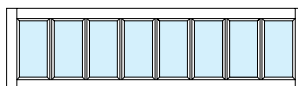

8768

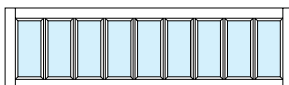

8769



MDF fire-rated doors and frames.

WHETHER RESIDENTIAL OR COMMERCIAL APPLICATIONS, CAPTIVA FIRE-RATED DOORS ALLOW YOU TO SEAMLESSLY MATCH THE CAPTIVA NON-RATED DOORS THROUGHOUT YOUR PROJECT. ALL OF OUR HUNDREDS OF PANEL DOOR DESIGNS AND MANY GLASS DOOR DESIGNS (SOME RESTRICTIONS ON SIZE) ARE AVAILABLE FIRE-RATED.

Fire-Rated Wood Door Frames

Our fire-rated wood door frames allow builders and architects to comply with the strictest building code requirements without sacrificing the design integrity of the project. A fire-resistant core is wrapped with MDF skins to perfectly match the non-rated door frames throughout the project. Our fire-rated door frames are also available in the wood species of your choice in stain grade, paint grade and prefinished. Our frames come standard with a patented adjustable clip system for fast and simple installation.

Fast Lead Times

Fire-rated doors and frames delivered to you in 2-3 weeks from approved shop drawings (*subject to change*).



TECHNICAL SPECS

Ratings <hr/> 20, 45, 60, and 90 minute positive pressure door and jamb ratings available	Wood Jamb <hr/> Fire-rated single rabbet, double rabbet, or communicator frame available	Metal Jamb <hr/> Available for all ratings
MDF or Wood Species <hr/> Available in stain grade, paint grade, and prefinished	Thickness <hr/> 1-3/4" and 2-1/4" door thicknesses available	Panels/Profiles <hr/> Available with flat or raised panels, and all sticking and panel profile designs
Design Options <hr/> All Captiva panel door designs and many glass door designs (some restrictions on glass size)	Custom Designs <hr/> Endless styles to meet your needs and perfect for unique designs or historical reproduction	Certification <hr/> Warnock Hersey Label, certified through Intertek Testing Service
Applicable Standards: ASTM E-152-81a, UL10(c)(1998), UBC 7-2(1997), UL10(b)(1997) NFPA 252(1999), ASTM E-2074(2000), CAN/ULC S104 1980 (R1985)		



CAPTIVA

Fire-rated wood jambs.

Captiva's fire-rated frames are available in 20-45-60-90 minute ratings. This innovative frame system helps ease the installation process through the use of adjustable metal clips, which provide additional strength while avoiding any exposed fasteners. This frame system also allows for easy removal and re-installation without damaging the finished frame. Intumescent edging is built into the jamb. During a fire, this edging expands to seal the room.

AVAILABLE IN YOUR CHOICE OF WOOD SPECIES OR PAINTED WHITE

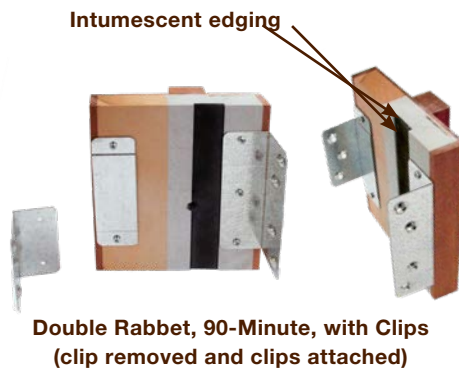

Single Rabbet, 60-Minute



Double Rabbet, 60-Minute



Single Rabbet, 90-Minute



Double Rabbet, 90-Minute

FIRE-RATED DOOR CORE

20-Minute Fire-Rated Door Cross Section

The fire core is installed between the panels, offering real stile and rail door construction. Intumescent edging goes around the fire core. During a fire, this edging expands to seal the room.

Intumescent edging when required



45-60-90-Minute Fire-Rated Door Cross Section

The door faces surrounding the core are built using actual panel, stile, and rail components to match the profiles of 20 minute and non-rated doors. Intumescent edging goes around the fire core. During a fire, this edging expands to seal the room.

Intumescent edging when required



Captiva Fire-Rated MDF or Wood Doors				
Rating	Maximum Door Size	Min Door Thickness	Listing Category	Max Glass Area (sq in)*
20-Minute	4/0 x 8/0 Single	1-3/4"	Category A, Category B Neutral Pressure	1,296
	7/0 x 8/0 Pair			
45-Minute	4/0 x 8/0 Single	1-3/4"	Category A, Category B	1,296
	7/0 x 8/0 Pair			
60-Minute	4/0 x 8/0 Single	1-3/4"	Category A, Category B	100†
	7/0 x 8/0 Pair			
90-Minute	4/0 x 8/0 Single	1-3/4"	Category A, Category B	100†

Fire-Rated Wood Jambs	
Rating	Maximum Jamb Size
20-Minute	4/0 x 8/0 Single
	8/0 x 8/0 Pair
45-Minute	4/0 x 8/0 Single
	8/0 x 8/0 Pair
60-Minute	4/0 x 8/0 Single
	8/0 x 8/0 Pair
90-Minute	4/0 x 8/0 Single
	8/0 x 8/0 Pair

*Glass must not be within 5" of edge or opening (bore) or be in a panel
 †For 60 and 90 minute, glass must be in a metal frame.

Metal jambs are also available for all single door applications and double door applications

How to order.



Specify	Example
Single or double prehung	Single
Door size and thickness	2/6 x 6/8 – 1-3/8"
Door style	8443
Species	MDF
Panel	Flat
Sticking	Square
Glass	Single Pane
Door swing (see 'Handing')	RH
Jamb (clear or primed / type)	Primed double rabbet
Wall thickness or jamb width	4-5/8"
Casing (clear or primed / type)	1 x 4 primed flat
Hinge size/type	3-1/2", 5/8 Radius
Hinge finish	Bright Brass
Hardware type and preps	Standard

Handing.

Pull the door towards you when standing on the side the hinge is exposed.
 If the knob is on the left of the door - LH
 If the knob is on the right of the door - RH

Single Doors



Double Doors



Jambs and casing.

Double Rabbetted Jamb

Primed and FJ double rabbet (DR) 4-11/16"

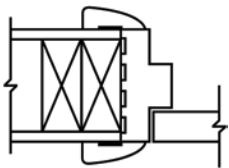

Single Rabbetted Jamb

Clear or primed single rabbet (SR) 4-5/8"

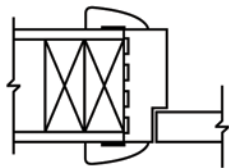

Flat Jamb

Clear or primed and FJ flat jamb 4-5/8" with WM888 E1E stops.

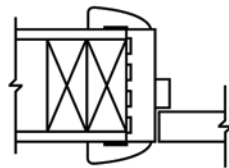

Split Jamb

Clear or primed and FJ split jamb 4-1/2" – 5-1/8" wall thickness.

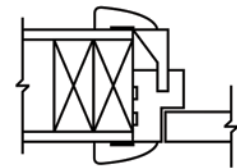

Custom jambs available in many species and sizes

Casing Patterns

2-1/2"

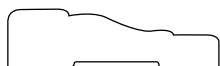

Colonial



Clam

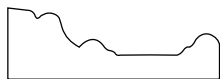

Baby Windsor

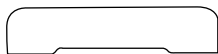

Chairrail

Or your choice of WindsorONE Mouldings or our Captiva Custom moulding patterns

3-1/2"

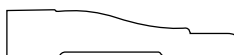

Colonial

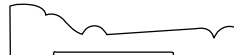

Stafford

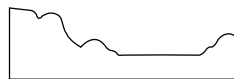

Windsor



Alexandria

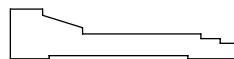

AB / HM9105-3

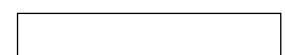

1 x 4 or 1 x 5

4-15/32"



AB / HM9105

ACCESS CONTROL IS AN IMPORTANT PART OF THE DOOR SYSTEM. IN RESIDENTIAL SETTINGS, A HOMEOWNER'S NUMBER ONE CONCERN IS SECURITY, BUT THEY ARE ALSO LOOKING FOR HARDWARE THAT IS DECORATIVE, COMPLEMENTING THE DOOR AND STYLE OF THEIR DÉCOR.

Interior Hardware

Interior door hardware enhances your interior doors with hundreds of design and finish combinations to choose from. We offer interior door hardware from Rocky Mountain, Baldwin, Emtek, Ashley Norton, Schlage and many other high quality suppliers.

Hinges

We offer a wide selection of hinges including 3-1/2", 4-1/2" and 5" in plain bearing and ball bearing, in a whole array of finishes to ensure that your door both functions perfectly and is aesthetically coordinated.

Baldwin



Egg Knob



5064 Knob



Filmore Knob



5069 Knob

Emtek



Stuttgart Lever



Octagon Knob



Helios Lever



Round Knob

Rocky Mountain



Paris



Flute Knob



Flute Lever



Convex Knob

Schlage Stock Hardware

Available in passage, privacy, bath, dummy, key, entrance and deadbolt



Plymouth

Brass
Chrome
Satin Nickel

Aged Bronze
Brass/Chrome
Black



Accent

Satin Nickel
Aged Bronze
Black



Commercial capabilities.



WHEN IT COMES TO THE DAILY WEAR AND TEAR OF PUBLIC USE, TRUST THE QUALITY AND VERSATILITY OF CAPTIVA CUSTOM MDF DOORS. OUR EXPERTISE WITH ALL PARTIES INVOLVED IN THE CONSTRUCTION PROCESS, AS WELL AS OUR ABILITY TO PROVIDE THE PROPER HARDWARE, MAKE CAPTIVA CUSTOM MDF DOORS THE PERFECT CHOICE FOR COMMERCIAL PROJECTS.



Prefinishing.



Fortress COATING SYSTEMS™

NOTHING BEATS THE CONVENIENCE AND SUPERIOR QUALITY OF A PROFESSIONALLY APPLIED FACTORY FINISH. FORTRESS COATING SYSTEMS™ USES THE LATEST TECHNOLOGY TO SAVE TIME AND PROVIDE CONSISTENT QUALITY. FORTRESS FINISHES COME WITH A 10 YEAR WARRANTY.

Stock paint colors.

SW 2838 POLISHED MAHOGANY	SW 2848 ROYCROFT PEWTER	SW 6243 DISTANCE
SW 6244 NAVAL	SW 6258 TRICORN BLACK	SW 6454 SHAMROCK
SW 6502 LOCH BLUE	SW 6711 PARAKEET	SW 6799 SOAR
SW 6868 REAL RED	SW 6883 RAUCOUS ORANGE	SW 6902 DECISIVE YELLOW
SW 7005 PURE WHITE	SW 7048 URBANE BRONZE	SW 7510 CHATEAU BROWN
SW 7526 MAISON BLANCHE	SW 7593 RUSTIC RED	SW 7669 SUMMIT GRAY



Custom colors are also available. Please supply Sherwin Williams or Benjamin Moore paint number and name. Custom paint matching available with physical sample and extended lead time.

Due to variations of printing of this catalog, or viewing on a screen, actual colors may vary. Please ask your sales rep for color samples.

Captiva MDF doors warranty

Interior Use Only



North Atlantic Corp (NAC), manufacturer of Captiva Doors, warrants to the original purchaser of a Captiva MDF Door that the product shall be free from defects in material and workmanship for a period of 5 years. The warranty period shall commence on the date of delivery.

Should the product fail to conform to this warranty within the warranty period, NAC will, at its option, (i) repair the product, (ii) replace the product in its original state of purchase, or (iii) refund the price originally paid for the product.

Limitations and Exclusions: The following are not covered by the warranty.

- 1) Damage caused by failure to comply with the instructions in the Captiva Door Use & Care Guide
- 2) MDF is warranted for interior use only.
- 3) Any door that is over 42" in width and/or 96" in height.
- 4) Warp that does not exceed 1/4" in the plane of the door itself for doors not over 36" x 84". Warp that does not exceed 3/8" in the plane of the door itself for doors over 36" x 84". Note: Captiva may defer repairing or replacing the product for up to 12 months from the date of installation or claim, as the warp may prove temporary as the door adjusts to weather conditions. This deferral will not count against the warranty period.
- 5) Damage caused by anyone other than a NAC representative while attempting to repair the product.
- 6) Damage caused by improper installation.
- 7) Damage caused by trimming more than 1" total of the product.
- 8) Doors trimmed at the top, more than 1" at bottom, or more than 1/4" at each side.
- 9) Damage caused by nonalignment or bow in the frame or jamb in which the door is hung.
- 10) Variations in gloss level, texture, or appearance resulting from field finishing.
- 11) Panel shrinkage or expansion due to natural characteristics of wood movement.
- 12) Gaps in stile and rail joints of 1/16" or less.
- 13) Damage caused by failing to seal all six sides and hardware cutouts of the door. Doors must be sealed within 72 hours of fitting and/or hanging.
- 14) Damage caused by any cause beyond the control of Captiva, including, but not limited to, normal wear and tear, weathering, customer misuse/ abuse/neglect, or acts of nature.
- 15) Doors shipped out of the continental US.
- 16) Any costs or charges relating to the replacement of the product, including transportation, shipping, removal, finishing, and installation.
- 17) Damage caused by failure of glazing, if the manufacturer's warranty period for that glazing has expired.



Warranty Claims

Warranty claims must be submitted within 30 days of discovery of the believed issue. Claims must be submitted via email to techsupport@northatlanticcorp.com or in writing to Captiva Wood Doors Warranty Claims, 1255 Grand Army Hwy, Somerset, MA, 02726 and must include proof of purchase of product. Photos are requested with any submissions.

Express Limitation

This warranty sets forth Captiva's maximum liability for its products. No other warranty expressed or implied, with respect to its product is made. NAC's liability is limited to the refund of the purchase price or repair or replacement of the defective product. This warranty is non-transferable.

Disclosure

Formal acceptance of this warranty is not required. By accepting delivery of the product, the customer is also accepting the terms and conditions of the Captiva MDF Doors limited warranty.



CAPTIVA

Architectural specifications.

ARCHITECTURAL SPEC: MDF DOORS, INTERIOR USE ONLY

Door construction, unless specified differently shall include a stave core method that uses a laminated stable wood core sandwiched between MDF veneers. Door panels are either 1/2", 5/8", 1-1/4", 1-1/2" solid or back to back panels based on panel design. Doors are built with 1/8" veneers (or greater depending on door thickness) on all stiles and rails with solid wood edges to help prevent warp or distortion. Mortise and tenon joinery is utilized in combination with the finest quality adhesives available. This method of assembly is time tested and backed by our full warranty.

Multi-lite doors, as true divided lite (TDL), with 1/8" single pane, 5/8" IG glass, or 5/8" Low E glass and wood stops. Muntin bar widths are 1", 1-1/8", and 1-3/8". Simulated divided light (SDL) with 7/8" SDL bar, and 11/16" duplex muntins. Wood bars applied to both faces of door.

Captiva Custom website.

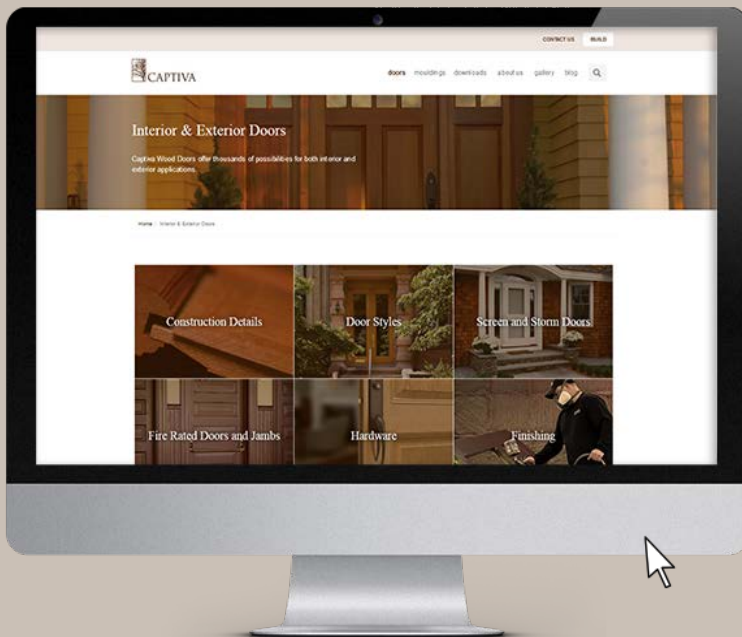

EXPLORE

- Our door designs
- Prefinishing in our facility
- Commercial capabilities
- Hardware
- Construction details
- Made in the USA

INTERACTIVE SPEC BOOK AND CAPTIVA DOOR CATALOG AVAILABLE ONLINE

- Access specifications for each individual Captiva door style
- Print or save the PDF for your reference
- Download DWG files for each door style
- Download the Captiva catalog

LINK TO CAPTIVA BUILD

- Design and quote your custom Captiva door online



www.CaptivaCustom.com



1255B GRAND ARMY HIGHWAY, SOMERSET, MA 02726

PHONE 800-899-4533

2049 SILAS DEANE HIGHWAY, SUITE 1A, ROCKY HILL, CT 06067

PHONE 800-486-7600

120 DEFREEST DRIVE, SUITE 19 (RENSSELAER TECHNOLOGY PARK), TROY, NY 12180

PHONE 800-350-0448

COMMERCIAL OFFICES

220 FORBES ROAD, SUITE 403, BRAINTREE, MA 02184

PHONE 800-225-4252



CLEARYWHOLESALE.COM

**VISIT CAPTIVACUSTOM.COM FOR A WIDE RANGE OF COORDINATING
INTERIOR AND EXTERIOR DOORS AVAILABLE IN ANY WOOD SPECIES**

